



## By-law No. 2009-075

"A By-law to Provide for the Regulation of Traffic in the  
City of Owen Sound"

<b>Amended By By-law:</b>	<b>Passed On:</b>
2009-075 (Original)	May 4, 2009
2009-137	August 31, 2009
2009-211	December 7, 2009
2009-233	December 21, 2009
2010-039	February 16, 2010
2010-048	March 8, 2010
2010-082	April 12, 2010
2010-095	May 10, 2010
2010-105	June 14, 2010
2010-120	June 14, 2010
2010-153	July 26, 2010
2010-205	September 20, 2010
2010-241	December 6, 2010
2010-254	December 20, 2010
2011-119	July 4, 2011
2011-123	July 4, 2011
2011-130	July 18, 2011
2011-131	July 18, 2011
2011-132	July 18, 2011
2011-146	August 8, 2011
2011-184	September 26, 2011
2011-225	December 5, 2011
2011-233	December 19, 2011
2012-043	April 2, 2012
2012-047	April 16, 2012
2012-147	August 27, 2012
2012-167	September 24, 2012
2012-175	October 15, 2012
2012-224	December 17, 2012
2013-030	February 11, 2013
2013-038	March 4, 2013
2013-039	March 4, 2013
2013-058	April 8, 2013
2013-059	April 8, 2013
2013-096	May 27, 2013
2013-181	October 7, 2013
2013-189	October 21, 2013
2013-203	November 4, 2013
2014-068	May 12, 2014
2014-127	July 21, 2014
2014-152	September 9, 2014
2015-167	November 30, 2015
2016-094	June 27, 2016
2016-112	July 25, 2016
2016-123	August 22, 2016
2016-141	September 26, 2016
2016-153	October 31, 2016
2016-154	October 31, 2016

2017-047	April 10, 2017
2017-177	December 4, 2017
2018-041	March 19, 2018
2018-121	August 13, 2018
2018-145	October 29, 2018
2018-161	December 17, 2018
2019-021	January 21, 2019
2019-030	February 11, 2019
2019-060	April 15, 2019
2019-116	July 15, 2019
2019-170	October 7, 2019
2019-172	October 28, 2019
2019-197	December 16, 2019
2020-003	January 13, 2020
2020-019	February 10, 2020
2020-025	March 2, 2020
2020-127	November 16, 2020
2020-142	December 14, 2020
2021-051	May 3, 2021
2021-107	August 30, 2021
2022-108	November 7, 2022
2023-050	May 8, 2023
2023-092	July 24, 2023
2023-123	November 20, 2023
2024-135	December 2, 2024

***Consolidated Version****Revised December 3, 2024****Consolidated for Convenience Only***

This is a consolidation copy of a City of Owen Sound By-law for convenience and information. While every effort is made to ensure the accuracies of these by-laws, they are not official versions or legal documents. The original by-laws should be consulted for all interpretations and applications on this subject. For more information or original signed copies of by-laws please contact the City Clerk's Department.

**Table of Contents**

BY-LAW 2009-075 ..... 1

    PART 1 – DEFINITIONS ..... 1

    PART 2 – OBEDIENCE TO TRAFFIC REGULATIONS..... 5

    PART 3 – PARKING AND OPERATION OF VEHICLES ..... 5

    PART 4 – DESIGNATING THROUGH HIGHWAYS, YIELD, AND STOP SIGNS ..... 16

    PART 5 – DELEGATION OF AUTHORITY ..... 17

    PART 6 – MISCELLANEOUS, PENALTIES, ETC. .... 18

SCHEDULE "1" ANGLE PARKING..... 20

SCHEDULE "2" NO STOPPING ..... 21

SCHEDULE "3" BOULEVARD PARKING ..... 24

SCHEDULE "4" COMPLIMENTARY 2 HOUR PARKING ..... 25

SCHEDULE "5" *REPEALED* ..... 26

SCHEDULE "6" *REPEALED* ..... 27

SCHEDULE "7" COMPLIMENTARY 5 HOUR PARKING IN LOTS ..... 28

SCHEDULE "8" NO PARKING ANYTIME ..... 29

SCHEDULE "9" NO PARKING - SPECIFIED TIME ..... 36

SCHEDULE "10" 10 MINUTE PARKING - ANYTIME ..... 39

SCHEDULE "11" HEAVY VEHICLE ROUTES ..... 40

SCHEDULE "12" ONE WAY STREETS ..... 42

SCHEDULE "13" RATE OF SPEED IN CERTAIN AREAS..... 43

SCHEDULE "14" NO LEFT TURNS..... 45

SCHEDULE "15" RIGHT TURNS ONLY ..... 46

SCHEDULE "16" NO U TURNS ..... 47

SCHEDULE "17" PARKING FEES ..... 48

SCHEDULE "18" MUNICIPAL PARKING LOTS – METERS PROVIDED ..... 49

SCHEDULE "19" MUNICIPAL PARKING LOTS - PAY AND DISPLAY MACHINES  
                    PROVIDED ..... 50

SCHEDULE "20" EMERGENCY PARKING FOR STORM STAYED MOTORISTS..... 51

SCHEDULE "21" LOADING AND UNLOADING ..... 52

SCHEDULE "22" SCHOOL BUS LOADING AND UNLOADING ZONE ..... 54

SCHEDULE "23" ACCESSIBLE PARKING SPACES ..... 55

SCHEDULE "24" CHILD CARE CENTRE LOADING AND UNLOADING ZONE..... 57

SCHEDULE "25" YIELD RIGHT OF WAY ..... 58

SCHEDULE "26" THROUGH HIGHWAYS ..... 59

SCHEDULE "27" STOP SIGNS ..... 63

SCHEDULE 28 – RESERVED PARKING ..... 71

**BY-LAW 2009-075****THE CORPORATION OF THE CITY OF OWEN SOUND****A BY-LAW TO PROVIDE FOR THE REGULATION OF  
TRAFFIC IN THE CITY OF OWEN SOUND**

WHEREAS The Corporation of the City of Owen Sound is desirous of regulating traffic within its boundaries;

NOW THEREFORE THE COUNCIL OF THE CORPORATION OF THE CITY OF OWEN SOUND HEREBY ENACTS AS FOLLOWS:

**PART 1 – DEFINITIONS**

1. For the purpose of this By-law:
- 1.1 **Authorized Sign** shall mean a sign approved by the Ministry of Transportation of the Province of Ontario or a sign approved by the City which includes words or symbols which describe a permitted or prohibited act and which have been erected by authorized agents of the City pursuant to this By-law and without limiting the generality of the foregoing, includes a traffic control device and a traffic control signal.

*Amended by By-law No. 2013-039*

- 1.2 **Accessible Parking Permit** means an unexpired accessible parking permit issued under O. Reg. 581 of the Highway Traffic Act.
- 1.3 **Bicycle** means and includes bicycle, tricycle or motor assisted bicycle.
- 1.4 **Boulevard** means City-owned property being part of a street, or road allowance other than the portion thereof used for vehicular traffic, or as a sidewalk for pedestrians, a driveway, or shoulder.
- 1.5 **By-law Enforcement Officer** means an enforcing officer appointed by the City to enforce the provisions of this By-law or a person specially appointed to enforce only specific provisions of this By-law.
- 1.6 **Child Care Centre Loading and Unloading Zone** means an area of a highway designated for loading to a Motor Vehicle, or unloading from a Motor Vehicle, of Child Care Students.
- 1.7 **City** means the Corporation of the City of Owen Sound.
- 1.8 **City Hall** means the municipal offices of the City located at 808 – 2<sup>nd</sup> Avenue East, Owen Sound, Ontario N4K 2H4.

*Amended by By-law No. 2013-203*

- 1.9 **City of Owen Sound Parking Permit** means a permit issued for a fee or to persons associated with the City which may exempt persons from certain regulations in this by-law.
- 1.10 **Coin** means either coin of the Dominion of Canada or of the United States of America.
- 1.11 **Commercial Motor Vehicle** means any motor vehicle having permanently attached thereto a truck or delivery body and includes, but is not limited to, ambulances, hearses, casket wagons, fire apparatus, buses and tractors used for hauling purposes on the highways.
- 1.12 **Corner** means the point of intersection of curbs or edges on the portion of the highway used for vehicular traffic.
- 1.13 **Council** means the municipal Council of The Corporation of the City of Owen Sound.
- 1.14 **Crosswalk** means that part of a highway at an intersection which is included within the connections of the lateral lines of the sidewalks on opposite sides of the highway measured from the curbs, or, in the absence of curbs, from the edges of the travelled portion of the highway or any portion of a roadway at an intersection or elsewhere distinctly indicated for

pedestrian crossing by signs including a Traffic Control Device or Traffic Control Signal or by lines or other markings on the road surface.

- 1.15 **Curb** includes the edge of a traveled portion of the highway.
- 1.16 **Delivery Vehicle** means a vehicle used by a company or individual for the exclusive purpose of delivery and/or taking away of merchandise.
- 1.17 **Driveway** means a public or private roadway providing vehicular access to a street or highway.
- 1.18 **Emergency Vehicle** means a fire department vehicle, a vehicle used by a police officer while on duty, or an ambulance.
- 1.19 **Extended Term** means a period of consecutive time for up to 9 hours.
- 1.20 **Fire Department Vehicle** means a vehicle owned and operated by the City, another municipality, or a rescue organization, as defined in the Highway Traffic Act, as amended from time to time.
- 1.21 **Funeral Home** means a building and the owners, or operators thereof, used for the preparation of deceased persons for burial or cremation and rituals relating thereto, and shall include a Place of Worship or other place where a funeral is held.
- 1.22 **Funeral Procession** means a row of motor vehicles leaving from a Funeral Home and proceeding at a slow-moving pace as part of a funeral.
- 1.23 **Heavy Vehicle** means a commercial vehicle having a total rated vehicle weight when unloaded of two (2) tonnes or more according to the Highway Traffic Act registration permit number relating thereto, said weight being transmitted to the highway, but does not include an ambulance, or police, or fire department vehicle, or public utility vehicle or a school bus engaged in transporting children to or from school functions.
- 1.24 **Heavy Vehicle Route (Full Time)** means a route in the City of Owen Sound on the streets designated for heavy vehicle traffic to travel 24 hours a day, 7 days a week and **Heavy Vehicle Route (Daytime)** means a route in the City on the streets designated for heavy vehicle traffic to travel between the hours of 6:00 am. and 9:00 p.m., 7 days a week.
- 1.25 **Highway** – See “Street or Highway”

*Amended by By-law 2013-039*

- 1.26 **Highway Traffic Act** means the Highway Traffic Act, RSO 1990, c H.8 as amended from time to time.

*Amended by By-law 2016-154 and 2019-060*

- 1.27 **Hours of Dedicated Enforcement** when referring to parking, means parking during the hours when Dedicated Parking Enforcement Officers of the City are actively enforcing parking regulations, being Monday to Friday from 9:00 a.m. to 5:00 p.m., excluding Holidays.
- 1.28 **Holiday** includes any day declared to be a holiday by the City, and includes Sunday, New Years Day, Good Friday, Easter Monday, Victoria Day, Canada Day, Civic Holiday, Labour Day, Thanksgiving Day, Remembrance Day, Christmas Day, Boxing Day, and when any holiday, falls on a Sunday, the next following day is in lieu thereof a holiday.
- 1.29 **Intersection** means the area embraced within the prolongation or connection of the lateral curb lines or, if none, then of the lateral boundary lines of two or more roadways which join one another at an angle, whether or not one crosses the other.

*Amended by By-law No. 2018-145*

- 1.29.1 **Large Vehicle** means any motor vehicle or combination towing motor vehicle and trailer having an overall height greater than 3.5 metres or overall length greater than 7.5 metres, with external attachments to the vehicle included in the overall height and length.
- 1.30 **Loading and Unloading Berth** means a space for the loading or unloading or both of goods or material for delivery of the same.

*Amended by By-law 2016-154 and 2019-060*

- 1.31 **Long Term Parking** when permitted, means parking during the Hours of Dedicated Enforcement of this By-law for up to five hours of permitted parking time within a parking space.

*By-law 2013-189*

- 1.32 **Lot** when used in the Schedules attached to this By-law shall mean one of the Municipal Parking Lots identified in Schedules 7A, 7B and 7C of this By-law.

*Amended by By-law No. 2019-197*

- 1.33 **Market Building** means the building used for the Owen Sound Farmer's Market located at 88 8<sup>th</sup> Street East.
- 1.34 **Motor Bus** means a class of urban Transit bus designed or intended for transporting, for compensation, passengers, and which is operated on a highway for or on behalf of the City.
- 1.35 **Motor Bus Stop Area** means any location where an authorized sign depicting a Motor Bus symbol is installed.
- 1.36 **Motor Vehicle** includes an automobile, motorcycle, motor assisted bicycle unless otherwise indicated in the Highway Traffic Act and any other vehicle propelled or driven otherwise than by muscular power, but does not include a street car or other motor vehicles running only upon rails, or a motorized snow vehicle, traction engine, farm tractor, self-propelled implement of husbandry or road-building machine within the meaning of the Highway Traffic Act.
- 1.37 **Municipal Parking Lot** means an off street parking area owned by the City or operated by the City pursuant to an agreement with the owner thereof.
- 1.38 **Off Street Parking Permission** means a letter from the City granting permission to a person to park on the Boulevard.
- 1.39 **Official Sign** means a sign approved by the Ministry of Transportation of the Province of Ontario or the City.
- 1.40 **One Way Street** means a street upon which vehicular traffic is limited to movement in one direction.
- 1.41 **Overhead Lane Designation Sign** means an Authorized Sign which is in some way installed so that it is suspended above the highway to be visible to the operators of Motor Vehicles.
- 1.42 **Park or Parking**, when prohibited, means the standing of a motor vehicle, whether occupied or not, except when standing temporarily for the purpose of and while actually engaged in loading or unloading merchandise or passengers.

*By-law 2012-043*

- 1.43 **Parking Enforcement Officer** means any person authorized by the City to enforce the provisions of *the Traffic By-law No. 2009-075 and amendments thereto*.
- 1.44 **Parking Meter** means a device including electronic and mechanical parking meters, and which indicates thereon the length of time during which a vehicle may be parked, which has as a part thereof a receptacle for receiving and storing coins, a slot or place in which coins may be deposited to activate a timing mechanism to indicate the passage of the interval of time, following the deposit of a coin therein, the length of which time is determined by the coin or coins deposited, and which also displays a signal when the paid-for interval of time has expired.
- 1.45 **Repealed by By-law 2019-060**
- 1.46 **Repealed by By-law 2019-060**
- 1.47 **Parking Space or Parking Stall** means a space marked off for the parking, within its markings, of a motor vehicle, on a street or highway, or in a municipal parking lot.

1.48 **Repealed by By-law 2019-060**

1.49 **Pay and Display Machine** means a machine that, by having the correct amount of currency deposited into it, produces a ticket document that stipulates the date and time that a motor vehicle may be legally parked.

*By-law 2013-189*

1.50 **Pedestrian** means a person on foot, in a wheeled carriage or using a wheelchair or personal mobility device.

1.51 **Person** includes any person, firm, partnership, association, corporation, company, or organization of any kind.

*By-law 2013-039*

1.52 **Person with a Disability** means a Person with a Disability as defined under O. Reg. 581 of the Highway Traffic Act.

1.53 **Places of Worship** means a Church, Synagogue, Temple, Mosque, or other facility that is used for prayer by persons of similar beliefs.

1.54 **Police Officer** means a member of The Owen Sound Police Services or a person authorized by the Chief of Police to regulate or direct traffic.

1.55 **Public Utility** means a system that is used to provide services or things for the public with respect to water; sewage; fuel, including natural and artificial gas; energy, including electricity; heating and cooling; telephone; and, the service or thing that is provided.

1.56 *Repealed (By-law 2013-189)*

1.57 **Roadway** means the portion of a street or highway improved, designed, or ordinarily used for vehicular traffic, but does not include the shoulder, and, where a highway includes two or more separate roadways, the term roadway refers to any one roadway separately and not to all of the roadways collectively.

1.58 **School Bus Loading Zone** means an area on a highway designated for the loading into a school bus or unloading from a school bus, of school students.

1.59 **School Day** means a day that is within a school year and is not a holiday, as determined by the Education Act.

1.60 **Seasonal** with respect to the parking of bicycles means the months of May, June, July, August, September, and October.

*Amended by By-law No. 2016-154*

1.61 **Short Term Parking** where permitted, means parking during the Hours of Dedicated Enforcement of this By-law for less than or equal to two hours of permitted parking time within a parking space.

1.62 **Shoulder** means the area between the moving traffic lanes of a street or highway, and the curb or edge of the roadway.

1.63 **Sidewalk** means that portion of a street or highway that lies between the roadway and the lateral property lines of the street or highway, and which may be paved, surfaced, or levelled, and is intended to be used as a pedestrian walkway.

1.64 **Stand or Standing**, when prohibited, means the halting of a motor vehicle whether occupied or not, except for the purpose of and while actually engaged in receiving and discharging passengers.

1.65 **Stop**, when required, means a complete cessation of movement.

1.66 **Stop or Stopping**, when prohibited, means any stopping of a motor vehicle, except when necessary to avoid conflict with other traffic or in compliance with the direction of a Police Officer, or traffic control sign or signal.

1.67 **Street or Highway** includes a common and public highway, street, avenue, parkway, crescent, court, public driveway, square, place, bridge, viaduct or trestle, any part of which is intended for or used by the general

public for the passage of vehicles and includes the area between the lateral property lines thereof.

- 1.68 **Through Highway** means a highway or part of a highway designated as such by the Minister of Transportation or by By-law of the City and every such highway intersecting or abutting the designated through highway shall be marked by a stop sign or yield right of way sign in compliance with the regulations of the Ministry of Transportation.
- 1.69 ***Repealed by By-law 2019-060***
- 1.70 **Tour Bus** shall mean any bus used for transporting passengers for the purpose of viewing various areas of the City.
- 1.71 **Traffic** includes the movement or stopping of pedestrians, ridden or herded animals, motor vehicles, motor buses, and other conveyances, either singly or together, while using any street or roadway.
- 1.72 **Traffic Control Device** means any sign, or roadway, curb or sidewalk markings, or other device erected or placed under the authority of the City for the purpose of guiding or directing traffic.
- 1.73 **Traffic Officer** means a Police Officer or any other person who is properly authorized by the Chief of Police to direct or regulate traffic.
- 1.74 **Traffic Control Signal** means any device manually, electrically, or mechanically operated for the regulation of traffic.
- 1.75 **Trailer** means a vehicle that is at any time drawn upon a highway by a motor vehicle, except an implement of husbandry, another motor vehicle or any device or apparatus not designed to transport persons or property temporarily drawn, propelled or moved upon such highway, and except a side car attached to a motorcycle, and shall be considered a separate vehicle and not part of the motor vehicle by which it is drawn.
- 1.76 **U-turn** means to turn a vehicle within a roadway so as to proceed in the opposite direction.

## **PART 2 – OBEDIENCE TO TRAFFIC REGULATIONS**

### **Enforcement of By-law**

- 2.1 The Police Officers of the Owen Sound Police Services and By-law Enforcement Officers for the City shall enforce the provisions of this By-law. Notwithstanding the foregoing, Parking Enforcement Officers appointed by the City shall enforce the provisions of this By-law, as amended from time to time, particularly within the Parking Meter Zones and within Municipal Parking Lots. Special By-law Enforcement Officers appointed by the City may also enforce the provisions of this By-law.

### **Obedience to Traffic Signals**

- 2.2 No person shall fail to promptly obey a Traffic Control Signal given either by a Police Officer or by a Traffic Control Device or a Traffic Control Signal.

### **Obedience to Parking Regulations**

- 2.3 Notwithstanding any other provisions of the By-law, if a Motor Vehicle is parked contrary to the By-law, in addition to any other remedy, a Police Officer or By-law Enforcement Officer may remove such Motor Vehicle, or cause same to be removed to and be stored in a suitable place, and all costs and charges for removal or storage thereof shall be a lien upon such Motor Vehicle.

## **PART 3 – PARKING AND OPERATION OF VEHICLES**



**Method of Parking**

- 3.1.1 No person shall Park a Motor Vehicle on any Street other than a one-way Street unless on the right-hand side of the Street, having regard for the direction in which the vehicle had been proceeding, and unless the right-front and right-rear wheels or runners of the Motor Vehicle are parallel to and distant, respectively, not more than 150 mm from the edge of the Roadway, provided that this provision shall not apply where angle parking is specifically authorized by By-law.

**Angle**

- 3.2.1 Angle parking is permitted in those areas so designated in **Schedule 1**.
- 3.2.2 In the said areas so designated, no person shall Park a Motor Vehicle except at the angle indicated by a marking or sign and so that the front end of the Motor Vehicle is nearest to the edge of the Roadway.
- 3.2.3 No person shall Park a truck over 454 kg (½ ton) classification in an area where angle parking is permitted.
- 3.2.4 No person shall Park a vehicle in angle parking a vehicle which has a trailer attached thereto, or where any load on the vehicle extends beyond the rear of the vehicle, or where the vehicle so parked obstructs or interferes with Traffic.

**One-way Streets**

- 3.3 Where Parking is permitted on a one-way Street, no Person shall Park a vehicle except so that the vehicle is facing in the direction in which it was legally proceeding and, except for areas where angle parking is permitted, parallel to and distant not more than 150 mm from the edge of the Roadway.

**Stopping Prohibited**

*Amended by By-law No. 2019-116*

- 3.4.1 No person shall allow any Motor Vehicle or part thereof to Stop anytime upon any Highway or parts of Highways set out in Column 1, on the side or sides set out in Column 2 and between the limits set out in Column 3 of **Schedule 2A** to this By-law.

*Amended by By-law No. 2019-197*

- 3.4.1.1 *No person shall allow any Motor Vehicle or part thereof to Stop between the hours of 8:00 a.m. and 5:00 p.m. on School Days upon any Highway or parts of Highways set out in Column 1, on the side or sides set out in Column 2 and between the limits set out in Column 3 of **Schedule 2B** to this by-law.*
- 3.4.2 Notwithstanding the provisions of Section 3.4.1 hereof, Motor Buses at signed bus stops shall be permitted to Stop anytime upon any Highway or parts of Highways set out in Column 1, on the side or sides set out in Column 2 and between the limits set out in Column 3 of **Schedule 2A** to this By-law while loading and unloading transit passengers.
- 3.4.3 Notwithstanding the provisions of Section 3.4.1 hereof, armoured vehicles under contract with a financial institution, in the process of picking up from, or delivering cash or other materials to, said financial institutions may Stop anytime upon any Highway or parts of Highways set out in Column 1, on the side or sides set out in Column 2 and between the limits set out in Column 3 of **Schedule 2A** to this By-law with the exception of 10<sup>th</sup> Street East and 10<sup>th</sup> Street West where the prohibition of Stopping contained in paragraph 3.4.1 hereof shall apply to armoured vehicles the same as other vehicles.

- 3.4.4 No person shall Stop or Stand a Motor Vehicle in, or within six metres from, a Crosswalk.

**Parking Prohibited – General**

- 3.5 No person shall at any time Park a vehicle or any part thereof, in any of the following places, except as herein expressly permitted:
- 3.5.1 on a Sidewalk;
  - 3.5.2 on a Boulevard, save and except a Boulevard as specified on **Schedule 3** to this By-law;
  - 3.5.3 in front of a public or private Driveway or lane;
  - 3.5.4 within an Intersection;
  - 3.5.5 within 1.8 m from the point where a straight line drawn from a fire hydrant at right angles to the roadway intersects the Roadway;
  - 3.5.6 on a Crosswalk;
  - 3.5.7 on any bridge or the approaches thereto;
  - 3.5.8 on any Street in such a manner as to obstruct Traffic;
  - 3.5.9 in such a position as will prevent the convenient removal of any other vehicle previously Parked or Standing;
  - 3.5.10 in front of the main entrance to, or any emergency exit from a theatre, auditorium, or other building while large assemblages are being held in such theatre, auditorium, or other building, or for a reasonable time immediately preceding and following such assemblages;
  - 3.5.11 in front of the entrance to a hotel
  - 3.5.12 in front of the entrance to any hospital;
  - 3.5.13 in any public lane;
  - 3.5.14 on any Roadway for an unreasonable time, having regard for the Traffic requirements of such Roadway;
  - 3.5.15 on any Highway between the hours of 1:00 a.m. and 7:00 a.m. during the period December 1<sup>s</sup> to March 31<sup>st</sup>;
  - 3.5.16 *Repealed (By-law 2013-189)*
  - 3.5.17 notwithstanding the provisions of Section 3.5 of this By-law, where an Authorized Sign has been installed and is on display, doctor's vehicles and Emergency Vehicles may Park up to, but not exceeding one hour, in the area of the sign;

*Amended by By-laws No. 2012-224 and 2017-047*

- 3.5.18 *Repealed.*

**Specified Places Where An Authorized Sign Is On Display – Anytime**

- 3.6 Where an Authorized Sign has been installed and is on display, no Person shall Park or leave standing any Motor Vehicle anytime:
- 3.6.1 within 9.1 metres of the Corner of any Street Intersection except where otherwise provided in this By-law;
  - 3.6.2 on the Highway or parts of Highways set out in Column 1, on the side or sides set out in Column 2, between the limits set out in Column 3 of **Schedule 8** of this By-law;
  - 3.6.3 Section 3.6.2 shall not apply to Motor Buses owned and operated by the City, or operated under a City franchise.

- 3.6.4 Where an Authorized Sign has been installed and is on display, no Person shall Park or leave Standing any unauthorized boat trailer in the parking lot at the Harry Lumley Bayshore Community Centre.

**Specified Places Where An Authorized Sign Is On Display – Specified Time**

- 3.7.1 Where an Authorized Sign has been installed and is on display, no Person shall Park or leave Standing, except in accordance with the time limits shown on the Authorized Sign, any Motor Vehicle on the Highway or parts of Highways, set out in Column 1, on the side or sides set out in Column 2 and between the limits set out in Column 3 of the following Schedules: **Schedules 9A, 9B, 9C, 9D, 9E, 9F, 9G, 9H, 9I, 9J, 9K, 9L, 9M, 9N, and 9O** to this By-law.
- 3.7.2 Where an Authorized Sign has been installed and is on display, no Person shall Park or leave Standing, any Motor Vehicle on the Highway or parts of Highways set out in Column 1, on the side or sides set out in Column 2 between the limits set out in Column 3 of **Schedule 9J** to this By-law during the period from December 1<sup>st</sup> to March 31<sup>st</sup>.
- 3.7.3 Where an Authorized Sign has been installed and is on display, no Person shall Park or leave Standing, any bicycle in the spaces identified for the parking of bicycles in the municipal parking lots identified as Lots 1, 4 and 5 set out in Column 1, between the time limits set out in Column 2 of **Schedule 9O** between May 1 and October 31 daily.

**Specified Places Where An Authorized Sign is On Display – Anytime With Certain Exceptions**

- 3.8 Where an Authorized Sign has been installed and is on display, no Person shall Park a Motor Vehicle on the Highway or parts of Highways set out in Column 1, on the side or sides set out in Column 2 and between the limits set out in Column 3 for **Schedule 10** to this By-law, except for the purpose of depositing mail and only for such period of time as required so to do not to exceed ten minutes.

**Heavy Vehicle**

- 3.9.1 When Authorized Signs have been installed and are on display, no Person shall move, drive or operate a Heavy Vehicle at any time on any Highway or parts of Highways except on the Highways or parts of Highways set out in Column 1 and between the limits set out in Column 2 and during the hours set out in **Schedule 11A, Heavy Vehicle Routes – Full Time or Schedule 11B, Heavy Vehicle Routes – Daytime (6:00 a.m. – 9:00 p.m.)** of this By-law.
- 3.9.2 The restrictions referred to in Section 3.9.1 shall not apply:
- 3.9.2.1 to any Heavy Vehicle actually engaged in making a delivery to or a collection from a premises which cannot be reached except by way of the Highway other than those referred to on **Schedules 11A or 11B**; or,
- 3.9.2.2 to prohibit the use of such Heavy Vehicle for such purposes provided that in making such delivery or collection the said Highway or parts of Highways are traveled only so far as is unavoidable in getting to or from such premises.
- 3.9.3 Where an Authorized Sign has been installed and is on display, no Person shall operate a Commercial Vehicle or Trailer on any Highway or parts of Highways in excess of allowable loading as defined by the Highway Traffic Act during a reduced load period designated as the months of March and April with the exception of the Highways or part of Highways as set out in Column 1 and between the limits set out in Column 2 of **Schedule 11C** to this By-law.

- 3.9.3.1 If deemed necessary by the Director of Public Works and Engineering or approved designate, the reduced load period referred to above may be extended to include the months of February and May.
- 3.9.4 Where authorized signs have been installed and are on display, no person shall move, drive or operate a Heavy Vehicle on any Highway or part of Highway except Tour Buses on the Highways or part of Highways set out in Column 1, between the limits set out in Column 2 and between the time limits set out in Column 3 of **Schedule 11D** to this By-law.
- 3.9.5 Where Authorized Signs have been installed and are on display, no Person shall Park or leave Standing, a Heavy Vehicle at any time on the Highway or parts of Highways set out in Column 1, on the side or sides set out in Column 2 and between the limits set out in Column 3 of **Schedule 11E** to this By-law.
- 3.9.6 The restrictions referred to in Section 3.9.5 shall not apply:
- 3.9.6.1 to a Heavy Vehicle actually engaged in making a delivery to or a collection from a premises which cannot be reached except by way of the Highway other than those referred to on **Schedules 11A, 11B, 11C and 11D**; or,
- 3.9.6.2 to prohibit the use of such Heavy Vehicle for such purposes provided that in making such delivery or collection the said Highway or parts of Highways as traveled only so far as is unavoidable in getting to or from such premises.

#### **Funeral And Other Processions**

- 3.10.1 Notwithstanding anything to the contrary contained in any City By-law prohibiting Parking on any Highway or portions thereof, no such prohibition shall apply to Motor Vehicles parked on a Highway in front of a Funeral Home establishment during the period of 1½ hours next preceding a funeral procession where the Funeral Home has caused signs to be placed on or adjacent to the Highway indicating that a funeral is about to take place.
- 3.10.2 No Person shall intersect a funeral or other properly authorized procession while it is in motion except under the direction of a Police Officer.
- 3.10.3 The driver of a Motor Vehicle in a funeral or other properly authorized procession shall drive as near to the right hand edge of the Roadway as practicable and, to shorten the procession to the extent reasonably possible, shall follow the vehicle ahead as closely as is practicable and safe.

#### **Emergency No Parking**

- 3.11 Notwithstanding anything to the contrary contained in any City By-law respecting Parking on any Highway or Street or portions thereof, no Person shall Park in any place where signs prohibiting Parking have been placed on display under the direction of Police Services, By-law Enforcement Officer, Public Works Manager, or other authorized employee of the City, for the purpose of snow removal, Street cleaning, weddings, or special events, provided however that said signs shall not become effective until two hours have elapsed after said signs have been so placed.

#### **Motor Bus Stops**

- 3.12 Where an Authorized Sign has been installed and is on display in the Motor Bus stop areas, no Person shall Park a Motor Vehicle, with the exception of doctors' vehicles and Emergency Vehicles which may park up to, but not exceeding one hour, Motor Buses owned or operated by the City, or under a City franchise.

#### **One-Way Streets Designated**

- 3.13.1 The Highways or parts of Highways set out in Column 1 of **Schedule 12** of this By-law between the limits set out in Column 2 of the said Schedule are hereby designated as One Way Streets in the direction set out in Column 3 of the said **Schedule 12**.
- 3.13.2 Where an Authorized Sign has been installed and is on display, no Person shall operate a Motor Vehicle on a One-Way Street except in the direction set out in Column 3 of the said **Schedule 12**.

#### **Rate of Speed in Certain Areas**

- 3.14.1 Where Authorized Signs have been installed and are on display and are marked in compliance with the regulations under the Highway Traffic Act, as amended from time to time, no Person shall operate a Motor Vehicle on any Highway set out in Column 1 of **Schedule 13A** to this By-law, between the distances set out in Column 2, at a rate of speed in excess of the rate of speed as set out in Column 3.
- 3.14.2 Notwithstanding section 3.14.1 the penalties provided in the Highway Traffic Act, R.S.O. 1990, Chapter H.8, Part IX, Section 128, or any amendment thereof, shall apply to the offences against this section with respect to connecting links within the City. For the purposes of this section, "connecting link" shall mean a portion of a King's Highway that is within the City boundaries.
- 3.14.3 Where Authorized Signs have been installed and are on display and are marked in compliance with the regulations under the Highway Traffic Act, as amended from time to time, no Person shall operate a Motor Vehicle between the hours of 8:00 a.m. and 5:00 p.m. on School Days upon any Highway set out in Column 2 of **Schedule 13B**, between the distances set out in Column 3, at a rate of speed in excess of 30 km/hour.

#### **Turns – Left Turns Prohibited**

- 3.15 Where an Authorized Sign has been installed and is on display, no Person operating a Motor Vehicle in the Intersection set out in Column 1, proceeding in the direction set out in Column 2 shall turn such vehicle to the left so as to enter an intersecting Roadway during the times set out in Column 3 of **Schedule 14** to this By-law.

#### **Right Turns Only**

- 3.16 Where an Authorized Sign has been installed and is on display, no Person operating a Motor Vehicle in the Intersection set out in Column 1 of **Schedule 15** to this By-law, proceeding in the direction set out in Column 2 shall enter the intersecting roadway except to turn to the right.

#### **U-Turns**

- 3.17 No person in charge of a Motor Vehicle shall on a Highway, turn the same in a half circle of 180 degrees:
- 3.17.1 when an Authorized Sign has been erected and is on display in the area as set out in **Schedule 16** to this By-law;
- 3.17.2 at any Intersection designated as a four way stop;
- 3.17.3 at any Intersection where traffic control signals are installed;
- 3.17.4 at any other place not mentioned in Sections 3.17.1, 3.17.2 and 3.17.3 unless it can be done in a safe manner and without interfering with other Traffic.

#### **Dealers Cars Prohibited**

- 3.18 No dealer of motor cars or Motor Vehicles shall Park or leave Standing, used or new vehicles on any Street, square or public place or on any property owned by the City:
- 3.18.1 for the purpose of displaying the Motor Vehicle for sale or resale, or in any way advertising the dealer's business or inventory; or
- 3.18.2 for the purpose of storing the Motor Vehicle pending servicing or delivery thereof to its owner or operator after servicing, or pending relocation of the same on the sales lot of the dealer.

### **Free Parking**

*Amended by By-laws 2012-224, 2016-154, 2017-047 and 2019-060*

- 3.19 *Repealed.*
- 3.19.1 *Repealed.*
- 3.19.2 *Repealed.*
- 3.19.2.1 *Repealed.*
- 3.19.2.2 *Where an Authorized Sign has been installed and is on display, no Person shall Park a Motor Vehicle in excess of two hours during the Hours of Dedicated Enforcement of this by-law, in each City block of the complementary parking area set out in Schedule 4 of this by-law.*
- 3.19.2.3 *Section 3.19.2.2 shall apply such that a Motor Vehicle may return to Park in the same location five hours after the time of initial parking."*

### **Metered Parking – Parking Meter Zones and Municipal Parking Lots**

- 3.20.1 *Repealed by By-law 2019-060.*
- 3.20.2 *Repealed by By-law 2019-060.*
- 3.20.3 *Repealed by By-law 2019-060.*
- 3.20.3.1 *Repealed by By-law 2019-060.*
- 3.20.3.2 *Repealed by By-law 2019-060.*
- 3.20.3.3 *Repealed by By-law 2019-060.*
- 3.20.4 *Repealed by By-law 2019-060.*
- 3.20.5 *Repealed by By-law 2019-060.*

### **Parking at Meters**

- 3.21.1 *Repealed by By-law 2019-060.*
- 3.21.2 *Repealed by By-law 2019-060.*
- 3.21.3 *Amended by By-law 2016-154 and repealed by By-law 2019-060.*
- 3.21.4.1 *Repealed by By-law 2019-060.*
- 3.21.4.2 *Repealed by By-law 2019-060.*
- 3.21.4.3 *Repealed by By-law 2019-060.*
- 3.21.5 *Repealed by By-law 2019-060.*
- 3.21.5.1 *Repealed by By-law 2019-060.*
- 3.21.6 *Repealed by By-law 2019-060.*

### **Legal Parking Time At Street Meters and in Municipal Parking Lots**

- 3.22.1 Notwithstanding any other provisions of this By-law, no Person shall Park a Motor Vehicle in a Parking Space in excess of the time on the days and between the hours hereafter specified:

*Amended by By-law 2019-060.*

- 3.22.1.1 no Person shall Park a Motor Vehicle for longer than a Short Term Parking time, as defined in this By-law, in the areas identified on **Schedule 4** to this By-law;

*Amended by By-law 2019-060.*

- 3.22.1.2 where an Authorized Sign has been installed and is on display, no person shall Park a Motor Vehicle for longer than a Long Term Parking time, as defined in this By-law, in the areas identified on **Schedule 7** to this By-law *unless a parking permit has been obtained.*

- 3.22.1.3 *Repealed by By-law 2019-060.*

- 3.22.2 *Repealed by By-law 2019-060..*

- 3.22.3 *Amended by By-laws 2011-123 and 2012-147 and Repealed by By-law No. 2016-154.*

### **Commercially Owned Vehicles (15 Minutes Parking) - In Parking Spaces With Parking Meters**

- 3.23.1 *Repealed by By-law 2019-060.*

- 3.23.2 *Repealed by By-law 2019-060.*

### **Interference With Authorized Signs and Parking Meters**

- 3.24.1 No Person shall alter, deface, move, remove or destroy any authorized sign, or any pavement lines or other marks for the Parking of Motor Vehicles or the regulation of Traffic.

*Amended by By-law 2019-060.*

- 3.24.2 No Person shall deface, injure, tamper with, open, wilfully break, destroy, move, remove, alter, or impair the usefulness of, any Parking Meter or Pay and Display Machine.

### **Areas Designated As Municipal Parking Lots**

*Amended by By-laws 2016-154 and 2019-060.*

- 3.25.1 *Areas designated as Municipal Parking Lots shall be those areas set out in Schedules 7 to this By-law.*

### **Parking in Municipal Parking Lots**

- 3.26 *Amended by By-law 2016-154 and repealed by By-law 2019-060.*

*Amended by By-law 2019-060.*

- 3.26.2 No Person shall Park a Motor Vehicle except a Tour Bus on the west side of Lot No. 8 described in **Schedule 7**, between the hours of 6 pm and 1 am daily.

### **Parking in Municipal Parking Lots – Where Pay and Display Machines are Provided**

- 3.27 *Amended by By-law No. 2016-154 and repealed by By-law 2019-060.*

- 3.27.1 *Repealed by By-law 2019-060.*

**Regulations**

3.28.1 *Repealed by By-law No. 2016-154.*

3.28.2 *Amended by By-law 2016-154 and repealed by By-law 2019-060.*

3.28.3 *Repealed by By-law 2019-060.*

3.28.4 *Repealed by By-law 2019-060.*

3.28.5 *Repealed by By-law 2019-060.*

3.28.5.1 *Repealed by By-law 2019-060.*

3.28.5.2 *Repealed by By-law 2019-060.*

3.28.5.3 *Repealed by By-law 2019-060.*

3.28.6 *Repealed by By-law 2019-060.*

3.28.7 *Repealed by By-law 2019-060.*

*Amended by By-law 2019-060.*

3.28.8 No Person shall operate a vehicle entering or making use of any public parking area except in accordance with the directions of any Authorized Signs, ~~Parking Meters~~, lines or other marks, and other permanent or temporary signal devices legally erected or placed for the purpose of regulating or directing Traffic within the said public parking area.

3.28.9 No Person shall Park a vehicle of over 2268 kg gross vehicle weight in any Municipal Parking Lot.

*Amended by By-law 2013-203 and By-law No. 2019-021*

3.28.10 *When Authorized Signs have been erected and are on display, no Person shall Park or leave Standing any Motor Vehicle in:*

3.28.10.1 *Parking Lots 1, 3, 8 and 9 between the hours of 2:00 a.m. and 7:00 a.m. from December 1 to March 31, save and except Parking Lot 9 where a person may park a Motor Vehicle upon paying the fee for an Overnight Parking Permit as set out in the Fees and Charges By-law and displaying the Permit in a visible place on the vehicle; and*

*Amended by By-law No. 2013-203 and By-law No. 2016-154*

3.28.10.2 *Parking Lots 4 and 5 between the hours of 2:00 a.m. and 5:00 a.m. from December 1 to March 31, save and except the designated overnight parking area in Parking Lot 5 where a person may park a Motor Vehicle upon paying the fee for overnight parking as set out in the Fees and Charges By-law and displaying the ticket document from a Pay and Display Machine in a visible place on the vehicle.*

3.28.10.3 *Amended by By-law 2014-152 and Repealed by By-law No. 2016-154.*

3.28.11 *Repealed by By-law 2019-060.*

**City of Owen Sound Parking Permits**

*Amended by By-law No. 2013-203*

3.29.1 *Persons with vehicles properly displaying a valid City of Owen Sound Parking Permit may be exempt from certain regulations in this by-law.*

3.29.2 *Repealed.*

3.29.3 No Person shall:

3.29.3.1 deface or alter any permit, sticker or other evidence of any permit furnished by the City;

3.29.3.2 use or permit the use of a defaced or altered permit, sticker or other evidence of a permit furnished by the City;



- 3.29.3.3 use or permit the use of a permit, sticker or other evidence of a permit furnished by the City except the person to whom the permit, sticker or other evidence of a permit is furnished;
- 3.29.3.4 without the authority of the person to whom a permit has been issued, remove a permit, sticker or other evidence of a permit furnished by the City from a Motor Vehicle.
- 3.29. 4 *Repealed.*

*By-law 2013-189*

- 3.29.5 *The provisions of Policy CrS-BL3 shall apply to Section 3.29 of this By-law. For the purposes of this section, a reference to Policy CrS-BL3 is ambulatory and applies as amended or succeeded.*

### **Where Meter Out Of Order**

- 3.30 *Repealed by By-law 2019-060.*

### **Emergency Or Special Circumstances**

*Amended by By-law 2019-060.*

- 3.31.1 Notwithstanding anything to the contrary contained herein, the Chief of Police or his designate, during any emergency or special circumstances deemed sufficient therefor, may, by the use of appropriate signs or signals, suspend the movement of any or all vehicular Traffic on any Street or portion thereof ~~in the Parking Meter Zone~~ and/or may suspend any or all Parking thereon by authorizing the affixing of "No Parking" signs or hoods to *parking meters*, and the Chief of Police or his/her designate, during such emergency, may declare that any Motor Vehicle already parked is being parked illegally regardless of the time permitted for Parking such Motor Vehicle under the provisions of this Section, and notwithstanding that the period allowed to the owner or driver under this Section has not expired.
- 3.31.2 Before exercising his authority pursuant to this Section, the Chief of Police shall cause to be made reasonable attempts to notify the owner or driver of such Motor Vehicle that Parking at such place has been suspended, and, the owner or driver of such Motor Vehicle shall be allowed a reasonable period of time to remove said Motor Vehicle before the Chief of Police causes the same to be removed, provided always that where an emergency requires it, this provision shall not apply.

### **Emergency Storm Stayed Motor Vehicles**

- 3.32.1 Notwithstanding anything to the contrary contained within this By-law, where an authorized sign has been installed and is on display, motorists who are storm-stayed as they cannot, due to heavy snowfalls, or icy road conditions remove their Motor Vehicles from any City Streets, may Park overnight in the designated spaces identified on the map attached as **Schedule 20** to this By-law in the Parking Lot located on the west side of 3<sup>rd</sup> Avenue East between 8<sup>th</sup> Street East and 9<sup>th</sup> Street East provided they have informed the Owen Sound Police Services of the need to leave their Motor Vehicle overnight.
- 3.32.2 Notwithstanding anything to the contrary contained herein, the Director of Operations, or his or her designate, during periods of heavy snow accumulation, may, by the use of appropriate signage, temporarily prohibit parking for a sufficient period of time to allow for City staff to remove snow on any road, metered or non-metered, or portion thereof, where the combination of accumulated snow and permitted parking creates an unsafe roadside environment provided however that said signage shall not become effective until two hours elapsed after said signage has been placed and after such time as the vehicle may be caused to be removed.

### **Loading and Unloading – Zone**

- 3.33 No Person shall Stop, Stand or Park a Motor Vehicle in a Loading or Unloading Berth except as follows:
  - 3.33.1 where Authorized Signs have been erected and are on display; and
  - 3.33.2 the Loading or Unloading Berth is as described in **Schedule 21A**; and
  - 3.33.3 where **Schedules 21B, 21C, 21D, and 21E** provide that Stopping, Standing or Parking in a Loading or Unloading Berth shall occur only between certain prescribed hours, the same shall occur only during the times set out on **Schedules 21B, 21C, 21D and 21E**.
  - 3.33.4 the Stopping, Standing or Parking is, subject to subparagraph 3.33.1, for the purpose of:
    - 3.33.4.1 loading or unloading goods or material; or
    - 3.33.4.2 engaging in the loading or unloading of passengers into or out of the said vehicle.
  - 3.33.5 Notwithstanding subparagraphs 3.33.1, 3.33.2, 3.33.3 and 3.33.4 hereof, no Person shall Stop, Stand or Park a Motor Vehicle in a Loading or Unloading Berth to engage in loading or unloading passengers when the same interferes with any Delivery Vehicle waiting to enter such Loading or Unloading Berth for the purpose of loading or unloading goods or materials.
  - 3.33.6 No Person shall Stop, Stand or Park in a Tour Bus Loading or Unloading Berth as Described in **Schedule 21D** except for the purpose of Loading or Unloading passengers and such loading and unloading time limit shall be 30 minutes.

#### **Method of Loading and Unloading**

- 3.34 In a Loading and Unloading Berth, no Person shall load or unload a Motor Vehicle unless the Motor Vehicle is Standing parallel to the Curb and with the wheels within 300 mm of the Curb; but, if it is impossible to load and unload any Motor Vehicle from the side it may be backed up to the Curb but shall not remain backed up to the Curb except during the actual loading or unloading on any of the following parts of Streets listed in **Schedules 21A, 21B, 21C, 21D and 21E** to this By-law.

#### **School Bus Loading Zone**

- 3.35 When Authorized Signs have been erected and are on display, no Person at anytime shall Stop, Stand or Park a Motor Vehicle on any Highway or portion of Highway set out in Column 1 of **Schedule 22** to this By-law, on the side or sides set out in Column 2 and between the limits set out in Column 3, the said areas being hereby designated as School Bus Loading Zones.

#### **Accessible Parking**

- 3.36 Where an Authorized Sign is erected and on display, no Person at any time shall Stop, Stand or Park a Motor Vehicle in any Parking Space or area designated for the use of vehicles displaying an Accessible Parking Permit described in **Schedule 23** of this By-law unless the person properly displays an Accessible Parking Permit on the Motor Vehicle.
  - 3.36.1 Section 3.36 does not apply to a Person operating Motor Vehicle which is Standing to receive or discharge a passenger who is a Person with a Disability.
  - 3.36.2 *Repealed by By-law 2019-060.*
    - 3.36.2.1 *Repealed by By-law 2019-060.*
    - 3.36.2.2 *Repealed by By-law 2019-060.*

*Amended by By-law 2019-060.*

- 3.36.3 ~~For greater certainty and without limiting section 3.36.2 of this by-law, a Person who properly displays an Accessible Parking Permit on a Motor Vehicle is subject to all Parking time limits and other regulations set out in this by-law.~~

### **Child Care Center Loading and Unloading Zones**

- 3.37 When Authorized Signs have been erected and are on display, no Person at anytime shall Stop, Stand or Park a Motor Vehicle on any Highway or portion of Highway set out in Column 1, on the side or sides set out in Column 2 and between the limits set out in Column 3 of **Schedule 24** of this By-law, except for the purpose of taking on and discharging children enrolled in a Child Care Centre for which the Loading and Unloading Zone has been provided and only for such period of time as required to do so, but not exceeding ten minutes.

### **Blocking Intersections**

- 3.38.1 When approaching a Traffic Control Signal at an intersection showing a circular green or green arrow indicator, no Person being the driver or operator of a Motor Vehicle shall enter the Intersection unless Traffic in front of him or her is moving in a manner that would reasonably lead him or her to believe that he or she can clear the Intersection before the signal indicator changes to a circular red indicator.
- 3.38.2 This section does not apply to the driver or operator of a Motor Vehicle who enters an Intersection for the purpose of turning to the right or left into an intersecting Highway and signals his or her intention to make such turn prior to entering the Intersection, and provided the driver or operator completes his or her turn as soon as it is safe to do so.
- 3.38.3 This section applies to all Intersections of Highways under the jurisdiction of the City which have a Traffic Control Signal at the said Intersections.

*Amended by By-law No. 2018-145*

### **Large Vehicles Prohibited**

- 3.39.1 *Large Vehicles are prohibited from parking on any City Street between the hours of 1:00 a.m. and 7:00 a.m. save and except during the annual event period of the Salmon Spectacular.*
- 3.39.2 *Unattached trailers are prohibited from being parked on any City Street between the hours of 1:00 a.m. and 7:00 a.m. save and except during the annual event period of the Salmon Spectacular.*

*Amended by By-law No. 2019-197*

### **Reserved Parking**

- 3.40.1 *Where Authorized Signs have been installed and are on display, no Person other than the Persons set out in Column 1 shall Park a Motor Vehicle on the City lands set out in Column 2 during the hours set out in Column 3 of **Schedule 28** to this by-law.*

## **PART 4 – DESIGNATING THROUGH HIGHWAYS, YIELD, AND STOP SIGNS**

### **Overhead Lane Designation Signs**

- 4.1 Where Authorized Signs being Overhead Lane Designation Signs are installed and on display at any Intersection, no Person being the driver or operator of a Motor Vehicle shall approach such Intersection except in a manner which complies with the said Overhead Lane Designation Signs.

**Yield Right-of Way Signs**

- 4.2.1 The Intersections on Highways set out in **Schedule 25** to this By-law are designated as Intersections where Yield Right-of-Way Signs shall be erected at the locations shown.
- 4.2.2 Where Authorized Signs being a Yield Right-of-Way Sign are installed and on display, no Person being the driver or operator of a Motor Vehicle shall fail to yield the right-of-way as directed by the sign.

**Through Highways**

- 4.3.1 The Highways or parts of Highways named or described in **Schedule 26** of this By-law are hereby declared to be Through Highways.

**Stop Signs**

- 4.4 The Intersections on Highways set out in Column 1 of **Schedule 27** to this By-law with such Highways set out in Column 3 of the said Schedule are hereby designated as Intersections where Stop Signs shall be erected for Traffic proceeding in the direction set out in Column 2 of the said Schedule.

**No Exit**

- 4.5 Where Authorized Signs have been installed and are on display, no Person operating a Motor Vehicle on the Highway set out in Column 1 of **Schedule 28** of this By-law proceeding in the direction set out in Column 2 shall exit such Motor Vehicle onto the Highway set out in Column 3.

**PART 5 – DELEGATION OF AUTHORITY***By-law 2013-058*

- 5.1 *The Director of Operations or their designate is hereby appointed by the City as the officeholder with the authority to temporarily designate a Highway or portion of a Highway under the City's jurisdiction as a construction zone for the purpose of and during the period required for, construction, repair or improvement of the Highway or other services.*
- 5.2 *Where a highway or portion of a highway under the City's jurisdiction has been designated as a construction zone, the Director of Operations or their designate may:*
- 5.2.1 *temporarily set a lower rate of speed for motor vehicles driven in the designated construction zone than is otherwise provided in the Highway Traffic Act or the City's Traffic By-law as applicable; or*
- 5.2.2 *temporarily close any highway or portion thereof which is designated as a construction zone.*
- 5.3 *Until such time as the signs are posted in accordance with the Highway Traffic Act, a construction zone, speed limit or road closure established under sections 5.1 or 5.2 of this by-law shall not become effective.*
- 5.4 *Council may, at their discretion:*
- 5.4.1 *revoke, by by-law, the authority provided in sections 5.1 or 5.2 of this by-law; or*
- 5.4.3 *direct the Director of Operations to designate a construction zone and temporarily set a lower rate of speed or close a highway in the construction zone by resolution.*

*By-law 2013-203*

- 5.5 *The Director of Operations and the Director of Community Services or their designates are hereby appointed by the City as the officeholder with the*

*authority to temporarily designate Parking Spaces for the use of vehicles displaying an Accessible Parking Permit during public events.*

- 5.5.1 *Where an Authorized Sign is erected and on display, a Parking Space temporarily designated under this section may be enforced in the same manner as a Parking Space described in section 3.36 of this by-law.*
- 5.6 *Council may, at their discretion:*
  - 5.6.1 *revoke, by by-law, the authority provided in section 5.5 of this by-law; or*
  - 5.6.3 *direct the Director of Operations or Director of Community Services to designate Parking Spaces for the use of vehicles displaying an Accessible Parking Permit during public events by resolution.*

## **PART 6 – MISCELLANEOUS, PENALTIES, ETC.**

### **Standard Time and Daylight Saving Time**

- 6.1 Whenever in this By-law a time of day or hour is referred to, it shall be constructed in accordance with Standard Time or Daylight Saving Time as may be in official current use in the City.

### **Removal of Motor Vehicle to be Stored**

- 6.2 Where an Authorizing Sign has been installed and is on display any Police Officer or By-law Enforcement Officer, upon discovery of any Motor Vehicle or other object parked or left in contravention of this By-law, may cause it to be moved, removed, impounded, restrained, or immobilized, or taken to and placed or stored in a suitable place and all costs and charges for removing, care and storage thereof, if any, are a lien upon the vehicle, which may be enforced in the manner provided in the Repair and Storage Liens Act of Ontario.
- 6.2.1 Any perishable object found in the object or vehicle removed from the highway pursuant to Section 6.2 herein, is the property of the City upon being moved from the highway and may be destroyed or given to a charitable institution.

### **Ontario Highway Traffic Act to Govern**

- 6.3 The provisions of this By-law shall be subject to the provisions of the Highway Traffic Act, Chapter H.8, R.S.O. 1990, as amended from time to time.

### **Penalty**

- 6.4 Any person who contravenes the provisions of this By-law is guilty of an offence and upon conviction therefore is subject to the penalty set out in the Provincial Offences Act.
  - 6.4.1 Any person may within 14 days of an Offence, choose the voluntary payment for the Offence as approved by the Regional Senior Justice.
  - 6.4.2 Following 14 days of an Offence, the set fine for the Offence, as approved by the Regional Senior Justice shall apply.

### **Headings Not Part Of This By-law**

- 6.5 The headings in the body of this By-law form no part of the By-law but are inserted for convenience of reference only.

### **Gender**

- 6.6 In this By-law words importing the masculine gender include females as well as males, and the converse.

**By-laws Repealed**

- 6.7 Following approval of short form wording for By-law 2009-075 by the Regional Senior Justice, By-Law 2003-148, and amendments thereto being: 2003-192, 2004-040, 2004-060, 2004-071, 2004-127, 2004-134, 2004-153, 2004-170, 2004-181, 2005-057, 23005-080, 2005-132, 2006-032, 2006-042, 2006-082, 2006-199, 2006,239, 2007-026, 2007-097, 2007-157, 2007-158, 2007-204, 2008-069, 2009-051, 2009-071 shall be deemed to be repealed.

**Effective Date**

- 6.8.1 All Signs, Traffic Control Devices, Traffic Control Signals Pay and Display Machines and Parking Meters, existing as at the effective date of this By-law which have been installed by employees or authorized agents of the City in accordance with the terms of the By-law of the City regulating Traffic and Parking at the time of the installing of the signs, and which signs comply with this By-law, are hereby deemed to be Authorized Signs as defined in this By-law.
- 6.8.2 The provisions of this By-law regulating Traffic, prohibiting or regulating the operation of Motor Vehicles or any type of class thereof, on a Highway designated as a connecting link pursuant to the Public Transportation and Highway Improvement Act, or any successor or replacement thereof, shall not become effective until approved by the Ministry of Transportation of Ontario and until Authorized Signs have been erected where required.
- 6.8.3 Subject to Section 6.8.2, the provisions of this By-law shall come into full force and effect upon approval of short form wording from the Regional Senior Justice and after the final passing of this By-law.
- 6.8.4 The provisions of this By-law regulating Traffic on any road that is designated as a Grey County road shall not become effective until approved by the County of Grey.

FINALLY PASSED AND ENACTED this 4<sup>th</sup> day of May, 2009.

Signature on file

Mayor

Signature on file

Clerk

SCHEDULE “1” ANGLE PARKING

SCHEDULE 1 – ANGLE PARKING			
Column 1	Column 2	Column 3	
Highway	Side(s)	From	To
1 <sup>st</sup> Avenue East	West	A point 67 m northerly from the north curb face of 8 <sup>th</sup> Street East	A point 137 m northerly
1 <sup>st</sup> Avenue West	East	A point 6.1 m southerly from the south curb face of 9 <sup>th</sup> Street West	A point 167.0 m southerly
	East	A point 6.1 m southerly from the south curb face of 10 <sup>th</sup> Street West	A point 159.1 m southerly
Schedule 1 amended by By-Law Nos. 2010-082 and 2011-119			

SCHEDULE “2” NO STOPPING

SCHEDULE 2A – NO STOPPING ANYTIME			
Column 1	Column 2	Column 3	
Highway	Side(s)	From	To
1 <sup>st</sup> Avenue East	East	North curb face of 10 <sup>th</sup> Street East	A point 128.0 m northerly
	West	North curb face of 10 <sup>th</sup> Street East	A point 135.0 m northerly
2 <sup>nd</sup> Avenue East	East	North curb face of 7 <sup>th</sup> Street East	A point 12.8 m northerly
	West	North curb face of 7 <sup>th</sup> Street East	A point 12 m northerly
	East	North curb face of 8 <sup>th</sup> Street East	A point 26.5 m northerly
	East	A point 110.4 m south of the south curb face of 8 <sup>th</sup> Street East	A point 28.6 m southerly
	East	South curb face of 8 <sup>th</sup> Street East	A point 30.6 m southerly
	West	North curb face of 8 <sup>th</sup> Street East	A point 23.5 m northerly
	West	South curb face of 8 <sup>th</sup> Street East	A point 31 m southerly
	West	A point 106 m south of the south curb face of 8 <sup>th</sup> Street East	A point 26 m southerly
	East	North curb face of 9 <sup>th</sup> Street East	A point 17.1 m northerly
	East	South curb face of 9 <sup>th</sup> Street East	A point 21.9 m southerly
	West	North curb face of 9 <sup>th</sup> Street East	A point 23.5 m northerly
	West	South curb face of 9 <sup>th</sup> Street East	A point 10.1 m southerly
	East	North curb face of 10 <sup>th</sup> Street East	A point 39 m northerly
	East	North curb face of 10 <sup>th</sup> Street East	A point 39 m northerly
	East	A point 103 m north of the north curb face of 10 <sup>th</sup> Street East	A point 139 m northerly
	East	South curb face of 10 <sup>th</sup> Street East	A point 31.1 m southerly
	West	North curb face of 10 <sup>th</sup> Street East	A point 35 m northerly
	West	South curb face of 10 <sup>th</sup> Street East	A point 18 m southerly
	West	A point 124.5 m north of the north curb face of 10 <sup>th</sup> Street East	A point 27.5 m northerly
	East	South curb face of 11 <sup>th</sup> Street East	A point 38 m southerly
	West	South curb face of 11 <sup>th</sup> Street East	A point 33 m southerly
3 <sup>rd</sup> Avenue East	East	North curb face of 8 <sup>th</sup> Street East	A point 10.1 m northerly
	West	North curb face of 8 <sup>th</sup> Street East	A point 20.1 m northerly
	East	North curb face of 9 <sup>th</sup> Street East	A point 14.9 m northerly
	East	South curb face of 9 <sup>th</sup> Street East	A point 22.6 m southerly



SCHEDULE 2A – NO STOPPING ANYTIME			
Column 1	Column 2	Column 3	
Highway	Side(s)	From	To
	West	North curb face of 9 <sup>th</sup> Street East	A point 14.6 m northerly
	West	South curb face of 9 <sup>th</sup> Street East	A point 17.7 m southerly
	East	North curb face of 10 <sup>th</sup> Street East	A point 39 m northerly
	East	South curb face of 10 <sup>th</sup> Street East	A point 51.2 m southerly
	West	North curb face of 10 <sup>th</sup> Street East	A point 22.6 m northerly
	West	South curb face of 10 <sup>th</sup> Street East	A point 22.6 m southerly
7 <sup>th</sup> Avenue East	West	North curb face of 15 <sup>th</sup> Street East	A point 107 m northerly
8 <sup>th</sup> Street East	North	East curb face of 2 <sup>nd</sup> Avenue East	A point 24.1 m easterly
	North	West curb face of 2 <sup>nd</sup> Avenue East	A point 22.3 m westerly
	South	West curb face of 2 <sup>nd</sup> Avenue East	A point 29 m westerly
	North	East curb face of 3 <sup>rd</sup> Avenue East	A point 23.8 m easterly
	North	West curb face of 3 <sup>rd</sup> Avenue East	A point 21.9 m westerly
	South	East curb face of 3 <sup>rd</sup> Avenue East	A point 31.9 m easterly
9 <sup>th</sup> Street East	South	East curb face of 1 <sup>st</sup> Avenue East	A point 15 m easterly
	North	East curb face of 2 <sup>nd</sup> Avenue East	A point 22.6 m easterly
	North	West curb face of 2 <sup>nd</sup> Avenue East	A point 26.5 m westerly (2011-130)
	South	East curb face of 2 <sup>nd</sup> Avenue East	A point 25 m easterly
	South	West curb face of 2 <sup>nd</sup> Avenue East	A point 26.5 m westerly
	North	East curb face of 3 <sup>rd</sup> Avenue East	A point 24.1 m easterly
	North	West curb face of 3 <sup>rd</sup> Avenue East	A point 21.9 m westerly
	South	East curb face of 3 <sup>rd</sup> Avenue East	A point 22.9 m easterly
	South	West curb face of 3 <sup>rd</sup> Avenue East	A point 23.8 m westerly
15 <sup>th</sup> Street East	North	East curb face of 6 <sup>th</sup> Avenue East	A point 29 m south easterly
10 <sup>th</sup> Street East and West	Both	East curb face of Alpha Street	West curb face of 9 <sup>th</sup> Avenue East
3 <sup>rd</sup> Avenue West	West	North curb face of 10 <sup>th</sup> Street West	A point 24 m northerly
	West	45 m north of the north curb face of 10 <sup>th</sup> Street West	South curb face of 11 <sup>th</sup> Street West
5 <sup>th</sup> Avenue West	East	North curb face of 8 <sup>th</sup> Street West	A point 13.1 m northerly
	West	North curb face of 8 <sup>th</sup> Street West	A point 13.1 m northerly
6 <sup>th</sup> Avenue West	East	South curb face of 8 <sup>th</sup> Street East	A point 140 m southerly
8 <sup>th</sup> Street West	North	East curb face of 5 <sup>th</sup> Avenue West	A point 15.2 m easterly

SCHEDULE 2A – NO STOPPING ANYTIME			
Column 1	Column 2	Column 3	
Highway	Side(s)	From	To
	North	West curb face of 5 <sup>th</sup> Avenue West	A point 16.5 m westerly
	South	East curb face of 6 <sup>th</sup> Avenue West	A point 210 m easterly
9 <sup>th</sup> Street West	South	West projected curb face of 1 <sup>st</sup> Avenue West	A point 15.5 m westerly
	South	2 <sup>nd</sup> Avenue West	A point 30 m easterly
Schedule 2A amended by By-law Nos. 2009-233, 2011-130, 2011-184 and 2020-019			

SCHEDULE 2B – NO STOPPING 8:00 AM – 5:00 PM on SCHOOL DAYS			
Column 1	Column 2	Column 3	
Highway	Side(s)	From	To
9 <sup>th</sup> Street West	North	8 <sup>th</sup> Avenue West	A point 130 m easterly
	North	7 <sup>th</sup> Avenue West	A point 155 m westerly
	South	7 <sup>th</sup> Avenue West	8 <sup>th</sup> Avenue West
25 <sup>th</sup> Street East	North	9 <sup>th</sup> Avenue East	the westerly terminus
Schedule 2B amended by By-law Nos. 2019-116, 2019-197 and 2023-092			

SCHEDULE “3” BOULEVARD PARKING

SCHEDULE 3 – BOULEVARD PARKING				
Column 1	Column 2	Column 3		Column 4
Highway	Side(s)	From	To	Restrictions
3 <sup>rd</sup> Avenue East	West	49 m South of the South curb face of 18th Street East	82.5 m south of 18th Street East South curb face	Parking by Valid City Permit Holders Only
7 <sup>th</sup> Avenue West	West	8 <sup>th</sup> Street West	9 <sup>th</sup> Street West	None
Any area to which Off Street Parking Permission has been granted by the City.				
Schedule 3 amended by By-law No. 2016-112				

SCHEDULE “4” COMPLIMENTARY 2 HOUR PARKING

SCHEDULE 4 – Complimentary 2 Hour Parking Monday to Friday 9:00 a.m. to 5:00 p.m.			
Column 1	Column 2	Column 3	
Highway	Side(s)	From	To
1 <sup>st</sup> Avenue East	East	A point 26.4 m south of the south curb face of 8 <sup>th</sup> Street East	A point 16.5 m southerly
	West	A point 42 m south of the south curb face of 9 <sup>th</sup> Street East	A point 84 m south
1 <sup>st</sup> Avenue West	East	8 <sup>th</sup> Street West	9 <sup>th</sup> Street West
2 <sup>nd</sup> Avenue East	East	7 <sup>th</sup> Street East	11 <sup>th</sup> Street East
	West	7 <sup>th</sup> Street East	11 <sup>th</sup> Street East
	Both	6 <sup>th</sup> Street East	7 <sup>th</sup> Street East
3 <sup>rd</sup> Avenue East	West	A point 12.2 m south of the south curb face of 8 <sup>th</sup> Street East	A point 10 m southerly
	Both	8 <sup>th</sup> Street East	10 <sup>th</sup> Street East
8 <sup>th</sup> Street East	South	1 <sup>st</sup> Avenue East	4 <sup>th</sup> Avenue East
	North	2nd Avenue East	4 <sup>th</sup> Avenue East
9 <sup>th</sup> Street East	North	A point 15.5m west of the west curb face of 1 <sup>st</sup> Avenue East	A point 13m westerly
	Both	1 <sup>st</sup> Avenue East	4 <sup>th</sup> Avenue East
9 <sup>th</sup> Street West	South	A point 30 m east of the east curb face of 2 <sup>nd</sup> Ave West	A point 21 m easterly
Schedule 4 amended by By-law Nos. 2012-224, 2019-060, 2019-170, 2019-172, 2019-197, 2020-142 and 2021-051			

**SCHEDULE "5" REPEALED**

➔ *Schedules 5A and 5B repealed by By-law 2019-060.*

**SCHEDULE "6" REPEALED**

➔ *Schedule 6 repealed by By-law 2016-154.*

SCHEDULE “7” COMPLIMENTARY 5 HOUR PARKING IN LOTS

SCHEDULE 7 – Complimentary 5 Hour Parking in Lots Monday to Friday 9:00 a.m. to 5:00 p.m.	
Column 1 Highway	Column 2 Description
Lot 1 – 8 <sup>th</sup> Street East	Along the north side of 8 <sup>th</sup> Street East, west of City Hall located at 808 2 <sup>nd</sup> Avenue East, and east of 1 <sup>st</sup> Avenue East
Lot 2 – 1 <sup>st</sup> Avenue West	Along the east side of 1 <sup>st</sup> Avenue West between 9 <sup>th</sup> Street West and 10 <sup>th</sup> Street West
Lot 3 – 3 <sup>rd</sup> Avenue East	Along the west side of 3 <sup>rd</sup> Avenue East, north of 10 <sup>th</sup> Street East between 10 <sup>th</sup> Street East and 11 <sup>th</sup> Street East, being composed of Part 3, Lot 1, west of Bay Street
Lot 4 – 3 <sup>rd</sup> Avenue East	Along the west side of 3 <sup>rd</sup> Avenue East, between 9 <sup>th</sup> Street East and 10 <sup>th</sup> Street East, being composed of Lots 12, 15, 17, 18, 19 and 34, Plan 850 and Lots 17, 18 and 19, Plan 5
Lot 5 – 3 <sup>rd</sup> Avenue East	Along the west side of 3 <sup>rd</sup> Avenue East, between 8 <sup>th</sup> Street East and 9 <sup>th</sup> Street East, being composed of Lot 9, west of Scrope Street and Part of Lot 9, east of Poulette Street with right of way, Plan 165, Part Lot 10, Poulette east side, Plan 165, Lot 10, Part Lot 11, Plan 163, Part Lot 1, Scrope west side
Lot 6 – 8 <sup>th</sup> Street East	Along the north side of 8 <sup>th</sup> Street East, west of 1 <sup>st</sup> Avenue East and east of the 8 <sup>th</sup> Street Bridge, adjacent to the Market Building
Lot 8 - 1 <sup>st</sup> Avenue East	Along the west side of 1 <sup>st</sup> Avenue East between 7 <sup>th</sup> Street East and 8 <sup>th</sup> Street East, being composed of broken front opposite Lot 17, south of Part Lot 16, west of Poulette Street, 53.9 meters to river and Part Lot 16, west, 26.1 meters to the river
Lot 9 – 1 <sup>st</sup> Avenue East	Along the east side of 1 <sup>st</sup> Avenue East between 7 <sup>th</sup> Street East and 8 <sup>th</sup> Street East, being composed of Part Lot 16, west of Poulette, RP 16R-8121, Part 3
Amended by By-law No. 2019-197	

→ Schedules 7A, 7B, 7C repealed by By-law 2019-060.

SCHEDULE “8” NO PARKING ANYTIME

SCHEDULE 8 – NO PARKING ANYTIME			
Column 1	Column 2	Column 3	
Highway	Side(s)	From	To
1 <sup>st</sup> Avenue East	East	7 <sup>th</sup> Street East	8 <sup>th</sup> Street East
	West	7 <sup>th</sup> Street East	8 <sup>th</sup> Street East
	West	North curb face of 8 <sup>th</sup> Street East	A point 66 m northerly
	East	8 <sup>th</sup> Street East	9 <sup>th</sup> Street East
	West	South curb face of 9 <sup>th</sup> Street East	A point 35 m southerly
	West	North curb face of 8 <sup>th</sup> Street East	A point 17 m northerly
	West	A point 49 m north of the north curb face of 8 <sup>th</sup> Street East	A point 22 m northerly
	Both	9 <sup>th</sup> Street East	10 <sup>th</sup> Street East
	East	South curb face of 9 <sup>th</sup> Street East	A point 32 m southerly
	East	11 <sup>th</sup> Street East	10 <sup>th</sup> Street East
	East	A point 113 m from the north curb face of 11 <sup>th</sup> Street East	A point 132 m from the north curb face of 11 <sup>th</sup> Street East
2 <sup>nd</sup> Avenue East	East	6 <sup>th</sup> Street East	Entrance to Harrison Park
	West	Projection of north curb face of 5 <sup>th</sup> Street A East	A point 47.7 m northerly
	West	Projection of the face of the south curb of 5 <sup>th</sup> Street A East	<del>A point 70.5 m southerly</del> Southerly City Limits
	East	North curb face of 6 <sup>th</sup> Street East	A point 16 m northerly
	Both	8 <sup>th</sup> Street East	A point 25 m southerly
	East	North curb face of 8 <sup>th</sup> Street East	A point 22.9 m northerly
	West	North curb face of 8 <sup>th</sup> Street East	A point 22.9 m northerly
	East	North curb face of 9 <sup>th</sup> Street East	A point 19.2 m northerly
	West	North curb face of 9 <sup>th</sup> Street East	A point 22.9 m northerly
	West	4 <sup>th</sup> Street 'B' East	Entrance to Harrison Park
	West	A point 53.3 metres from the south curb face of 12 <sup>th</sup> Street East	A point 16.7 m southerly
	West	North curb face of 10 <sup>th</sup> Street East	A point 22.9 m northerly
	West	South curb face of 10 <sup>th</sup> Street East	A point 35 m southerly
	Both	North curb face of 12 <sup>th</sup> Street East	A point 12.2 m northerly
	West	South curb face of 12 <sup>th</sup> Street East	A point 12.2 m southerly
	East	South curb face of 12 <sup>th</sup> Street East	A point <del>12.2</del> 30.0 m southerly
	East	17th Street East	18th Street East
	West	18th Street East	a point 62 metres south of the south curb face of 18th Street East
3 <sup>rd</sup> Avenue East	East	6 <sup>th</sup> Street East	8 <sup>th</sup> Street East
	West	North curb face of 6 <sup>th</sup> Street East	A point 22.9 m northerly
	West	North curb face of 7 <sup>th</sup> Street East	A point 21.3 m northerly



SCHEDULE 8 – NO PARKING ANYTIME			
Column 1	Column 2	Column 3	
Highway	Side(s)	From	To
	West	North curb face of 7 <sup>th</sup> Street East	A point 21.3 m northerly
	East	South curb face of 8 <sup>th</sup> Street East	A point 22.9 m southerly
	West	North curb face of 8 <sup>th</sup> Street East	A point 12.2 m southerly
	East	South curb face of 9 <sup>th</sup> Street East	A point 22.9 m southerly
	West	North curb face of 9 <sup>th</sup> Street East	A point 17.4 m northerly
	East	South curb face of 10 <sup>th</sup> Street East	A point 51 m southerly
	West	South curb face of 10 <sup>th</sup> Street East	A point 22.5 m southerly
	East	10 <sup>th</sup> Street East	18 <sup>th</sup> Street East
	West	North curb face of 10 <sup>th</sup> Street East	A point 53.3 m northerly
	West	North curb face of 11 <sup>th</sup> Street East	A point 18.3 m northerly
	West	South curb face of 11 <sup>th</sup> Street East	A point 18.3 m southerly
	West	12 <sup>th</sup> Street East	A point 59.4 m northerly
	West	14 <sup>th</sup> Street East	16 <sup>th</sup> Street East
	West	North curb face of 17 <sup>th</sup> Street East	A point 73 m northerly
4 <sup>th</sup> Avenue East	West	7 <sup>th</sup> Street East	8 <sup>th</sup> Street East
	East	South curb face of 8 <sup>th</sup> Street East	A point 22.9 m southerly
	West	North curb face of 8 <sup>th</sup> Street East	A point 22.9 m northerly
	East	South curb face of 9 <sup>th</sup> Street East	A point 22.9 m southerly
	West	A point 30.5 m south of the south curb face of 9 <sup>th</sup> Street East	A point 24.4 m southerly
	West	South curb face of 9 <sup>th</sup> Street East	A point 12 m southerly
	East	North curb face of 9 <sup>th</sup> Street East	A point 20 m northerly
	West	North curb face of 9 <sup>th</sup> Street East	A point 22.9 m northerly
		A point 53 m north of the north curb face of 9 <sup>th</sup> Street East	A point 19 m northerly
	Both	South curb face of 10 <sup>th</sup> Street East	A point 25 m southerly
	East	A point 51 m south of the south curb face of 10 <sup>th</sup> Street East	A point 22 m southerly
		A point 102 m south of the south curb face of 10 <sup>th</sup> Street East	A point 16 m southerly
	West	A point 42 m south of the south curb face of 10 <sup>th</sup> Street East	A point 31 m southerly
	West	North curb face of 10 <sup>th</sup> Street East	A point 22.9 m northerly
	East	A point 84.9 m north of the projected north curb face of 10 <sup>th</sup> Street East	A point 4.1 m northerly
5 <sup>th</sup> Avenue East	East	11 <sup>th</sup> Street East	18 <sup>th</sup> Street East
	East	8 <sup>th</sup> Street East	10 <sup>th</sup> Street East
	West	4 <sup>th</sup> Street East	5 <sup>th</sup> Street East

SCHEDULE 8 – NO PARKING ANYTIME			
Column 1	Column 2	Column 3	
Highway	Side(s)	From	To
	West	South curb face of 10 <sup>th</sup> Street East	A point 68.6 m southerly
5 <sup>th</sup> Avenue A East	West	North curb face of 8 <sup>th</sup> Street A East	A point 36.5 m northerly
	East	South curb face of 9 <sup>th</sup> Street East	A point 83.3 m southerly
	West	South curb face of 9 <sup>th</sup> Street East	A point 91.7 m easterly
7 <sup>th</sup> Avenue East	East	6 <sup>th</sup> Street East	10 <sup>th</sup> Street East
	West	A point 45.7 m south of the south curb face of 5 <sup>th</sup> Street East	A point 27.4 m southerly
7 <sup>th</sup> Avenue East	West	8 <sup>th</sup> Street East	A point 17.0 m northerly
8 <sup>th</sup> Avenue East	East	North curb face of 10 <sup>th</sup> Street East	A point 18.3 m northerly
	East	A point 53.3 m east of the east curb face of 10 <sup>th</sup> Street East	A point 114.3 m easterly
9 <sup>th</sup> Avenue East	Both	South City Limits	16 <sup>th</sup> Street East
	East	19 <sup>th</sup> Street East	20 <sup>th</sup> Street East
	Both	South curb face of 36 <sup>th</sup> Street East	A point 7.6 m southerly
10 <sup>th</sup> Avenue East	West	South curb face of 8 <sup>th</sup> Street East	A point 41.5 m northerly
11 <sup>th</sup> Avenue East	East	8 <sup>th</sup> Street East	10 <sup>th</sup> Street East
	West	8 <sup>th</sup> Street East	A point 23.0 m northerly
15 <sup>th</sup> Avenue East	West	14 <sup>th</sup> Street East	The southerly terminus including bulb and continuing on to a point 90m south of the south curb face of 14 <sup>th</sup> Street East
	East	South curb face of 14 <sup>th</sup> Street East	A point 15m southerly
16 <sup>th</sup> Avenue East	Both	8 <sup>th</sup> Street East	16 <sup>th</sup> Street East
20 <sup>th</sup> Avenue East	Both	The southern terminus	17 <sup>th</sup> Street East
1 <sup>st</sup> Street East	Both	East curb face of 2 <sup>nd</sup> Avenue East	A point 56.0 m easterly
4 <sup>th</sup> Street A East	South	East curb face of 2 <sup>nd</sup> Avenue East	A point 57.9 m easterly
5 <sup>th</sup> Street East	South	2 <sup>nd</sup> Avenue East	5 <sup>th</sup> Avenue East
	Both	2 <sup>nd</sup> Avenue East	A point 12 m westerly
5 <sup>th</sup> Street A East	North West	2 <sup>nd</sup> Avenue East	5 <sup>th</sup> Street East
6 <sup>th</sup> Street East	Both	2 <sup>nd</sup> Avenue East	9 <sup>th</sup> Avenue East
6 <sup>th</sup> Street East Service Road	North	7 <sup>th</sup> Avenue East	8 <sup>th</sup> Avenue East
7 <sup>th</sup> Street East	North	1 <sup>st</sup> Avenue East	2 <sup>nd</sup> Avenue East
	South	1 <sup>st</sup> Avenue East	3 <sup>rd</sup> Avenue East
	Both	East curb face of 5 <sup>th</sup> Avenue East	A point 69.5 m easterly
7 <sup>th</sup> Street A East	North	233 m west of the west curb face of 7 <sup>th</sup> Avenue East	The westerly limits of 7 <sup>th</sup> Street A East
	South	225 m west of the west curb face of 7 <sup>th</sup> Avenue East	The westerly limits of 7 <sup>th</sup> Street A East
8 <sup>th</sup> Street East	North	Bridge over Sydenham River	2 <sup>nd</sup> Avenue East
	South	Bridge over Sydenham River	1 <sup>st</sup> Avenue East
	North	East curb face of 3 <sup>rd</sup> Avenue East	A point 22.9 m westerly

SCHEDULE 8 – NO PARKING ANYTIME			
Column 1	Column 2	Column 3	
Highway	Side(s)	From	To
	South	A point 59.7 m east of the east curb face of 3 <sup>rd</sup> Avenue East	A point 65.8 m easterly
	South	West curb face of 3 <sup>rd</sup> Avenue East	A point 22.9 m westerly
	North	East curb face of 4 <sup>th</sup> Avenue East	A point 22.9 m easterly
	South	West curb face of 4 <sup>th</sup> Avenue East	A point 22.9 m westerly
	South	4 <sup>th</sup> Avenue East	5 <sup>th</sup> Avenue East
	Both	9 <sup>th</sup> Avenue East	28 <sup>th</sup> Avenue East
8 <sup>th</sup> Street A East	North	East curb face of 5 <sup>th</sup> Avenue East	A point 72.5 m easterly
	North	East curb face of 5 <sup>th</sup> Avenue A East	A point 83.6 m easterly
9 <sup>th</sup> Street East	North	East curb face of 1 <sup>st</sup> Avenue West	A point 41.5 m easterly
	Both	1 <sup>st</sup> Avenue East	1 <sup>st</sup> Avenue West
	North	East curb face of 2 <sup>nd</sup> Avenue East	A point 22.9 m easterly
	South	East curb face of 2 <sup>nd</sup> Avenue East	A point 20.4 m easterly
	South	West curb face of 2 <sup>nd</sup> Avenue East	A point 22.9 m westerly
	North	East curb face of 3 <sup>rd</sup> Avenue East	A point 22.9 m easterly
	South	A point 30.5 m east of the east curb face of 3 <sup>rd</sup> Avenue East	A point 18.3 m easterly
	South	West curb face of 3 <sup>rd</sup> Avenue East	A point 22.9 m westerly
	North	4 <sup>th</sup> Avenue East	Bottom of 9 <sup>th</sup> Street East stairs
	North	West curb face of 4 <sup>th</sup> Avenue East	A point 13.4 m easterly
	North	4 <sup>th</sup> Avenue East	A point 51.8 m westerly
	North	4 <sup>th</sup> Avenue East	Bottom of 9 <sup>th</sup> Street East stairs
	South	West curb face of 4 <sup>th</sup> Avenue East	A point 22.9 m westerly
	South	5 <sup>th</sup> Avenue A East	Bottom of stairs up 9 <sup>th</sup> Street East hill
	South	7 <sup>th</sup> Avenue East	8 <sup>th</sup> Avenue East
9 <sup>th</sup> Street A East	South	7 <sup>th</sup> Avenue East	8 <sup>th</sup> Avenue East
10 <sup>th</sup> Street East	Both	9 <sup>th</sup> Avenue East	11 <sup>th</sup> Avenue East
	South	West curb face of 11 <sup>th</sup> Avenue East	A point 10 m westerly
	South	East curb face of 11 <sup>th</sup> Avenue East	16 <sup>th</sup> Avenue East
	North	The projected east curb face of 11 <sup>th</sup> Avenue East	16 <sup>th</sup> Avenue East
10 <sup>th</sup> Street East and West	Both	West City Limits	9 <sup>th</sup> Avenue East
11 <sup>th</sup> Street East	North	3 <sup>rd</sup> Avenue East	A point 15.2 m easterly
	North	3 <sup>rd</sup> Avenue East	A point 24.4 m westerly
	South	3 <sup>rd</sup> Avenue East	4 <sup>th</sup> Avenue East

SCHEDULE 8 – NO PARKING ANYTIME			
Column 1	Column 2	Column 3	
Highway	Side(s)	From	To
12 <sup>th</sup> Street East	Both	East curb face of 2 <sup>nd</sup> Avenue East	A point 12.2 m easterly
	Both	West curb face of 2 <sup>nd</sup> Avenue East	A point 12.2 m westerly
	South	2 <sup>nd</sup> Avenue East	3 <sup>rd</sup> Avenue East
	North	3 <sup>rd</sup> Avenue East	4 <sup>th</sup> Avenue East
14 <sup>th</sup> Street East	South	2 <sup>nd</sup> Avenue East	3 <sup>rd</sup> Avenue East
	North	West curb face of 3 <sup>rd</sup> Avenue East	A point 22.9 m westerly
	South	3 <sup>rd</sup> Avenue East	4 <sup>th</sup> Avenue East
	Both	14 <sup>th</sup> Avenue East	16 <sup>th</sup> Avenue East
16 <sup>th</sup> Street East	Both	6 <sup>th</sup> Avenue East	9 <sup>th</sup> Avenue East
17 <sup>th</sup> Street East	North	3 <sup>rd</sup> Avenue East	4 <sup>th</sup> Avenue East
	Both	900 block of 17 <sup>th</sup> Street East	
18 <sup>th</sup> Street East	North	2nd Avenue East	3rd Avenue East
	Both	3rd Avenue East	4th Avenue East
19 <sup>th</sup> Street East	North	East curb face of 7 <sup>th</sup> Avenue East	A point 61.0 m easterly
36 <sup>th</sup> Street East	Both	East Bayshore Road	Easterly City Limits
	South	East curb face of East Bayshore Road	A point 76.2 m easterly
1 <sup>st</sup> Avenue West	East	Projected curb face of 8 <sup>th</sup> Street West	A point 33.5 m northerly
	West	8 <sup>th</sup> Street West	10 <sup>th</sup> Street West
	East	9 <sup>th</sup> Street West	A point 28.5 m northerly
	East	10 <sup>th</sup> Street West	12 <sup>th</sup> Street West
	East	South curb face of 10 <sup>th</sup> Street West	A point 24 m southerly
	West	10 <sup>th</sup> Street West	11 <sup>th</sup> Street West
	East	South curb face of 12 <sup>th</sup> Street West	A point 112.8 m southerly
	West	12 <sup>th</sup> Street West	A point 112.8 m southerly
	Both	14 <sup>th</sup> Street West	Northerly limit of 1 <sup>st</sup> Avenue West
2 <sup>nd</sup> Avenue West	East	Bottom of Moore’s Hill	Pottawatomi River
	West	Bottom of Moore’s Hill	6 <sup>th</sup> Street West
	West	8 <sup>th</sup> Street West	Pottawatomi River
Eddie Sargent Parkway	Both	Pottawatomi River Bridge	23 <sup>rd</sup> Street West
3 <sup>rd</sup> Avenue West	East	8 <sup>th</sup> Street West	The southerly limits of 3 <sup>rd</sup> Avenue West
	East	8 <sup>th</sup> Street West	12 <sup>th</sup> Street West
	East	North curb face of 10 <sup>th</sup> Street West	A point 43 m northerly
	East	South curb face of 11 <sup>th</sup> Street West	A point 10 m southerly
	West	North curb face of 11 <sup>th</sup> Street West	A point 22.9 m northerly
	East	16 <sup>th</sup> Street West	19 <sup>th</sup> Street West
	Both	South curb face of 23 <sup>rd</sup> Street West	A point 45.7 m southerly
4 <sup>th</sup> Avenue West	West	1 <sup>st</sup> Street West	8 <sup>th</sup> Street West
	West	9 <sup>th</sup> Street West	10 <sup>th</sup> Street West
	East	10 <sup>th</sup> Street West	23 <sup>rd</sup> Street West
	West	North curb face of 10 <sup>th</sup> Street West	A point 22.9 m northerly
	West	North curb face of 11 <sup>th</sup> Street West	A point 22.9 m northerly

SCHEDULE 8 – NO PARKING ANYTIME			
Column 1	Column 2	Column 3	
Highway	Side(s)	From	To
5 <sup>th</sup> Avenue West	East	28 <sup>th</sup> Street West	29 <sup>th</sup> Street West
	East	8 <sup>th</sup> Street West	9 <sup>th</sup> Street West
	West	15 <sup>th</sup> Street West	17 <sup>th</sup> Street West
	East	27 <sup>th</sup> Street West	28 <sup>th</sup> Street West
	West	South curb face of 28 <sup>th</sup> Street West	A point 35.1 m southerly
6 <sup>th</sup> Avenue West	Both	North curb face of 9 <sup>th</sup> Street West	A point 45.7 m northerly
	Both	South curb face of 9 <sup>th</sup> Street West	A point 45.7 m southerly
	East	12 <sup>th</sup> Street West	13 <sup>th</sup> Street West
	West	12 <sup>th</sup> Street West	Alpha Street
	West	13 <sup>th</sup> Street A West	Alpha Street
	East	28 <sup>th</sup> Street West	29 <sup>th</sup> Street West
7 <sup>th</sup> Avenue West	Both	7 <sup>th</sup> Street West	8 <sup>th</sup> Street West
	East	8 <sup>th</sup> Street West	9 <sup>th</sup> Street West
	Both	10 <sup>th</sup> Street West	West Hill Secondary School
	East	10 <sup>th</sup> Street West	11 <sup>th</sup> Street West
8 <sup>th</sup> Avenue West	West	9 <sup>th</sup> Street West	10 <sup>th</sup> Street West
3 <sup>rd</sup> Street West	North	2 <sup>nd</sup> Avenue East	the westerly terminus
6 <sup>th</sup> Street West	Both	East curb face of 2 <sup>nd</sup> Avenue West	A point 100 m easterly
8 <sup>th</sup> Street West	South	Bridge over Sydenham River	2 <sup>nd</sup> Avenue West
	North	Bridge over Sydenham River	3 <sup>rd</sup> Avenue West
	South	West curb face of 2 <sup>nd</sup> Avenue West	A point 22.9 m westerly
	South	West curb face of 3 <sup>rd</sup> Avenue West	A point 22.9 m westerly
9 <sup>th</sup> Street West	North	1 <sup>st</sup> Avenue West	2 <sup>nd</sup> Avenue West
	South	2 <sup>nd</sup> Avenue West	3 <sup>rd</sup> Avenue West
	North	West curb face of 2 <sup>nd</sup> Avenue West	A point 36.6 m westerly
	North	3 <sup>rd</sup> Avenue West	A point 12 m westerly
	North	A point 40 m west of the west curb face of 3 <sup>rd</sup> Avenue West	5 <sup>th</sup> Avenue West
	South	3 <sup>rd</sup> Avenue West	A point 17 m westerly
	South	A point 49 m west of the west curb face of 3 <sup>rd</sup> Avenue West	5 <sup>th</sup> Avenue West
	North	5 <sup>th</sup> Avenue West	6 <sup>th</sup> Avenue West
	South	7 <sup>th</sup> Avenue West	8 <sup>th</sup> Avenue West
10 <sup>th</sup> Street West	South	6 <sup>th</sup> Avenue West	8 <sup>th</sup> Avenue West
10 <sup>th</sup> Street A West	North	East curb face of 8 <sup>th</sup> Avenue West	A point 12.2 m easterly
11 <sup>th</sup> Street West	Both	1 <sup>st</sup> Avenue West	2 <sup>nd</sup> Avenue West
	South	East curb face of 4 <sup>th</sup> Avenue West	A point 18 m easterly
12 <sup>th</sup> Street West	North	1 <sup>st</sup> Avenue West	2 <sup>nd</sup> Avenue West
	South	West curb face of 1 <sup>st</sup> Avenue West	A point 17 metres westerly
	South	East curb face of 2 <sup>nd</sup> Avenue West	A point 17 metres easterly
	North	4 <sup>th</sup> Avenue West	6 <sup>th</sup> Avenue West
13 <sup>th</sup> Street West	North	1 <sup>st</sup> Avenue West	6 <sup>th</sup> Avenue West
13 <sup>th</sup> Street A West	North	4 <sup>th</sup> Avenue West	Alpha Street
	South	East curb face of Alpha Street	A point 12.2 m easterly
	South	West curb face of Alpha Street	A point 13 m easterly
14 <sup>th</sup> Street West	Both	1 <sup>st</sup> Avenue West	Alpha Street
	North-west	Northwest curb face of Alpha Street	A point 22.9 m north-westerly

SCHEDULE 8 – NO PARKING ANYTIME			
Column 1	Column 2	Column 3	
Highway	Side(s)	From	To
	South	Alpha Street	7 <sup>th</sup> Avenue West
15 <sup>th</sup> Street West	South	4 <sup>th</sup> Avenue West	7 <sup>th</sup> Avenue West
16 <sup>th</sup> Street West	North	3 <sup>rd</sup> Avenue West	4 <sup>th</sup> Avenue West
	South	West curb face of 3 <sup>rd</sup> Avenue West	A point 9.1 m westerly
	South	East curb face of 4 <sup>th</sup> Avenue West	A point 9.1 m easterly
18 <sup>th</sup> Street West	Both	Eddie Sargent Parkway	3 <sup>rd</sup> Avenue West
23 <sup>rd</sup> Street West	Both	3 <sup>rd</sup> Avenue West	4 <sup>th</sup> Avenue West
	South	4 <sup>th</sup> Avenue West	5 <sup>th</sup> Avenue West
28 <sup>th</sup> Street West	North	4 <sup>th</sup> Avenue West	6 <sup>th</sup> Avenue West
Alpha Street	South-east	14 <sup>th</sup> Street West	6 <sup>th</sup> Avenue West
	North-west	8 <sup>th</sup> Avenue West	9 <sup>th</sup> Avenue West
	North-west	6 <sup>th</sup> Avenue West	14 <sup>th</sup> Street West
Beattie Street	North	West curb face of 2 <sup>nd</sup> Avenue West	A point 61 m westerly
Schedule 8 amended by By-law Nos. 2011-130, 2011-131, 2011-225, 2012-175, 2013-059, 2013-096, 2014-068, 2014-127, 2016-112, 2016-141, 2018-041, 2018-121, 2019-170, 2019-197, 2021-051, 2022-108, 2023-050, 2023-092 and 2023-123			

SCHEDULE “9” NO PARKING - SPECIFIED TIME

SCHEDULE 9A – NO PARKING Sundays 7:00 a.m. to 10:00 p.m.			
Column 1	Column 2	Column 3	
Highway	Side(s)	From	To
7 <sup>th</sup> Avenue East	West	4 <sup>th</sup> Street East	4 <sup>th</sup> Street A East
4 <sup>th</sup> Street East	North	West curb face of 7 <sup>th</sup> Avenue East	A point 111 m westerly
4 <sup>th</sup> Street A East	South	West curb face of 7 <sup>th</sup> Avenue East	A point 93 m westerly

SCHEDULE 9B – NO PARKING - SCHOOL DAYS MONDAY TO FRIDAY 8:00 A.M. TO 9:00 A.M. 3:00 P.M. TO 4:00 P.M.			
Column 1	Column 2	Column 3	
Highway	Side(s)	From	To
15 <sup>th</sup> Street East	South	A point 281.5 m from the east curb face of 4 <sup>th</sup> Avenue East	7 <sup>th</sup> Avenue East
4 <sup>th</sup> Avenue West	East	7 <sup>th</sup> Street East	8 <sup>th</sup> Street East
Amended by By-law No. 2020-019, 2020-127			

SCHEDULE 9C – NO PARKING 8:30 A.M. TO 4:00 P.M. MONDAY TO FRIDAY INCLUSIVE			
Column 1	Column 2	Column 3	
Highway	Side(s)	From	To
4 <sup>TH</sup> Avenue East	East	A point 61.0 m south of the south curb face of 8 <sup>th</sup> Street East	A point 10.6 m southerly

SCHEDULE 9D – NO PARKING MAY 1 TO OCTOBER 7 6:00 P.M. TO 10:00 P.M. MONDAY TO FRIDAY INCLUSIVE			
Column 1	Column 2	Column 3	
Highway	Side(s)	From	To
5 <sup>th</sup> Avenue West	West	22 <sup>nd</sup> Street West	23 <sup>rd</sup> Street West
6 <sup>th</sup> Avenue West	East	7 <sup>th</sup> Street West	8 <sup>th</sup> Street West

SCHEDULE 9E – NO PARKING 3:30 P.M. TO 5:30 P.M. MONDAY TO FRIDAY INCLUSIVE			
Column 1	Column 2	Column 3	
Highway	Side(s)	From	To
7 <sup>th</sup> Avenue East	Both	South curb face of 6 <sup>th</sup> Street East	A point 206.3 m southerly

SCHEDULE 9F – NO PARKING 8:00 A.M. TO 6:00 P.M. MONDAY TO FRIDAY INCLUSIVE (Amended by By-law No. 2016-154)			
Column 1	Column 2	Column 3	
Highway	Side(s)	From	To
2 <sup>ND</sup> Avenue West	West	6 <sup>th</sup> Street West	8 <sup>th</sup> Street West

➔ *Schedule 9G repealed by By-law No. 2016-154*

SCHEDULE 9H – NO PARKING 8:00 A.M. TO 6:00 P.M. DAILY			
Column 1	Column 2	Column 3	
Highway	Side(s)	From	To
4 <sup>th</sup> Avenue East	West	A point 13.7 m south of the south curb face of 12 <sup>th</sup> Street East	A point 32 m southerly
1 <sup>st</sup> Avenue A West	East	11 <sup>th</sup> Street West	Southerly limit of 1 <sup>st</sup> Avenue A West
13 <sup>th</sup> Street West	South	1 <sup>st</sup> Avenue West	2 <sup>nd</sup> Avenue West

SCHEDULE 9I – NO PARKING 8:00 A.M. TO 5:00 P.M. SCHOOL DAYS (SCHOOL BUSES EXCEPTED)			
Column 1	Column 2	Column 3	
Highway	Side(s)	From	To
3 <sup>rd</sup> Avenue West	West	17 <sup>th</sup> Street West	19 <sup>th</sup> Street West
8 <sup>th</sup> Street West	South	A point 61 m east of the east curb face of 6 <sup>th</sup> Avenue West	A point 121.9 m easterly
9 <sup>th</sup> Street West	North	The west curb face of 7 <sup>th</sup> Avenue West	A point 155 m westerly
	North	A point 9.1 m east of the east curb face of 8 <sup>th</sup> Avenue West	A point 121 m easterly
9 <sup>th</sup> Avenue West	East	178.6 m south of the south curb face of 10 <sup>th</sup> Street West	A point 45.7 m southerly

*Amended by By-law No. 2019-197, 2020-127*

SCHEDULE 9J – NO PARKING DECEMBER 1 <sup>ST</sup> TO MARCH 31 <sup>ST</sup>			
Column 1	Column 2	Column 3	
Highway	Side(s)	From	To
4 <sup>th</sup> Avenue East	East	4 <sup>th</sup> Street East	5 <sup>th</sup> Street East
4 <sup>th</sup> Street East	South	6 <sup>th</sup> Avenue East	7 <sup>th</sup> Avenue East
4 <sup>th</sup> Street A East	North	6 <sup>th</sup> Avenue East	7 <sup>th</sup> Avenue East
8 <sup>th</sup> Street East	North	3 <sup>rd</sup> Avenue West	The walkway on 8 <sup>th</sup> Street East
	South	3 <sup>rd</sup> Avenue A West	The walkway on 8 <sup>th</sup> Street East
3 <sup>rd</sup> Street West	South	2 <sup>nd</sup> Avenue East	the westerly terminus

*Schedule 9J amended by By-law No. 2019-030 and 2023-092*

SCHEDULE 9K – TWO HOUR PARKING - Monday to Friday 8:00 A.M. to 4:00 P.M. September to June Inclusive Unless Exempted from this Provision by a Valid City On-street Parking Permit			
Column 1	Column 2	Column 3	
Highway	Side(s)	From	To
11 <sup>th</sup> Avenue East	West	A point 23 m northerly of the north curb face of 8 <sup>th</sup> Street East	A point 9 m southerly of the south curb face of 10 <sup>th</sup> Street East

*Schedule 9K amended by By-law Nos. 2013-189 and 2015-167*



SCHEDULE 9L – TWO HOUR PARKING MONDAY TO FRIDAY INCLUSIVE 9:00 A.M. TO 6:00 P.M.			
Column 1	Column 2	Column 3	
Highway	Side(s)	From	To
3 <sup>rd</sup> Avenue West	West	A point 91 m from the south curb face of 10 <sup>th</sup> Street West	A point 29 m southerly
Schedule 9L amended by By-law No. 2016-154			

SCHEDULE 9M – NO PARKING 8:00 A.M. TO 5:00 P.M. MONDAY TO FRIDAY			
Column 1	Column 2	Column 3	
Highway	Side(s)	From	To
4 <sup>TH</sup> Avenue East	West	South curb face of 12 <sup>th</sup> Street East	A point 61 m southerly
3 <sup>rd</sup> Avenue West	West	17 <sup>th</sup> Street West	18 <sup>th</sup> Street West

➔ Schedule 9N repealed by By-law No. 2016-154

SCHEDULE 9O – BICYCLE PARKING May 1 to October 31 Restricted Times			
Column 1	Column 2	Column 3	
Municipal Parking Lot	Location	Restricted Times From	Restricted Times To
Parking Lot 1 Behind City Hall	Where bicycle racks have been installed	1:00 a.m.	7:00 a.m.
Parking Lot 4 3 <sup>rd</sup> Avenue East between 9 <sup>th</sup> Street East and 10 <sup>th</sup> Street East	Where bicycle racks have been installed	2:00 a.m.	5:00 a.m.
Parking Lot 5 3 <sup>rd</sup> Avenue East between 8 <sup>th</sup> Street East and 9 <sup>th</sup> Street East	Where bicycle racks have been installed	3:00 a.m.	7:00 a.m.
Schedule 9O amended by By-law No. 2013-189			

SCHEDULE 9P – NO PARKING – Restricted Times			
Column 1	Column 2	Column 3	
Municipal Parking Lot	Location	Restricted Times From	Restricted Times To
Parking Lot 1	North side of 8th Street East behind City Hall between 1st Avenue East and 2nd Avenue East	1:00 a.m.	7:00 a.m.
Parking Lot 4	West side of 3rd Avenue East between 9th Street East and 10th Street East	3:00 a.m.	7:00 a.m.
Parking Lot 5	West side of 3rd Avenue East between 8th Street East and 9th Street East	2:00 a.m.	5:00 a.m.
Parking Lot 8	West Side of 1 <sup>st</sup> Avenue East between 7 <sup>th</sup> Street East and 8 <sup>th</sup> Street East	1:00 a.m.	7:00 a.m.
Parking Lot 9	East Side of 1 <sup>st</sup> Avenue East between 7 <sup>th</sup> Street East and 8 <sup>th</sup> Street East	1:00 a.m.	7:00 a.m.
Schedule 9P amended by By-law No. 2013-189			

SCHEDULE “10” 10 MINUTE PARKING - ANYTIME

SCHEDULE 10 – 10 MINUTE PARKING ANYTIME			
Column 1	Column 2	Column 3	
Highway	Side(s)	From	To
3 <sup>rd</sup> Avenue East	East	A point 14.9 m north of the north curb face of 9 <sup>th</sup> Street East	A point 30.5 m northerly
	West	A point 59.5 m north of the north curb face of 10 <sup>th</sup> Street East	A point 8.5 m northerly (In front of Transit Terminal)
	West	14.7 m north of the north curb face of 9 <sup>th</sup> Street East	A point 25.8 metres northerly

SCHEDULE “11” HEAVY VEHICLE ROUTES

SCHEDULE 11A – HEAVY VEHICLE ROUTES – FULLTIME (7 DAYS PER WEEK, 24 HOURS PER DAY)		
Column 1	Column 2	
Highway	From	To
3 <sup>rd</sup> Avenue East	10 <sup>th</sup> Street East	Northerly limit of the City on East Bay Shore Road
9 <sup>th</sup> Avenue East	Southerly entrance of the City on 9 <sup>th</sup> Avenue East	20 <sup>th</sup> Street East
16 <sup>th</sup> Avenue East	16 <sup>th</sup> Street East	20 <sup>th</sup> Street East
28 <sup>th</sup> Avenue East	8 <sup>th</sup> Street East	20 <sup>th</sup> Street East
8 <sup>th</sup> Street East	9 <sup>th</sup> Avenue East	28 <sup>th</sup> Avenue East
16 <sup>th</sup> Street East	9 <sup>th</sup> Avenue East	28 <sup>th</sup> Avenue East
20 <sup>th</sup> Street East	9 <sup>th</sup> Avenue East	28 <sup>th</sup> Avenue East
2 <sup>nd</sup> Avenue West	10 <sup>th</sup> Street West	Northerly limits of the City on 3 <sup>rd</sup> Avenue West
10 <sup>th</sup> Street West	Westerly limits of the City on 9 <sup>th</sup> Avenue West	9 <sup>th</sup> Avenue East

SCHEDULE 11B – HEAVY VEHICLE ROUTES – DAYTIME (7 DAYS PER WEEK, 6:00 A.M. TO 9:00 P.M.)		
Column 1	Column 2	
Highway	From	To
2 <sup>nd</sup> Avenue East	6 <sup>th</sup> Street East	City limits at 1 <sup>st</sup> Street South West
3 <sup>rd</sup> Avenue East	6 <sup>th</sup> Street East	10 <sup>th</sup> Street East
	28 <sup>th</sup> Street East	East Bayshore Road
6 <sup>th</sup> Avenue East	15 <sup>th</sup> Street East	16 <sup>th</sup> Street East
9 <sup>th</sup> Avenue East	20 <sup>th</sup> Street East	28 <sup>th</sup> Street East
6 <sup>th</sup> Street East	2 <sup>nd</sup> Avenue East	9 <sup>th</sup> Avenue East
15 <sup>th</sup> Street East	3 <sup>rd</sup> Avenue East	9 <sup>th</sup> Avenue East
16 <sup>th</sup> Street East	6 <sup>th</sup> Avenue East	9 <sup>th</sup> Avenue East
28 <sup>th</sup> Street East	9 <sup>th</sup> Avenue East	3 <sup>rd</sup> Avenue East
Alpha Street	10 <sup>th</sup> Street West	14 <sup>th</sup> Street West
14 <sup>th</sup> Street West	Alpha Street	2 <sup>nd</sup> Avenue West

SCHEDULE 11C – LOAD LIMIT – MARCH AND APRIL		
Column 1	Column 2	
Highway	From	To
3 <sup>rd</sup> Avenue East	6 <sup>th</sup> Street East	28 <sup>th</sup> Street East
6 <sup>th</sup> Avenue East	15 <sup>th</sup> Street East	16 <sup>th</sup> Street East
9 <sup>th</sup> Avenue East	28 <sup>th</sup> Street East	Southerly City limits
12 <sup>th</sup> Avenue East	16 <sup>th</sup> Street East	23 <sup>rd</sup> Street East
14 <sup>th</sup> Avenue East	16 <sup>th</sup> Street East	17 <sup>th</sup> Street East
	23 <sup>rd</sup> Street East	A point 280 m southerly
16 <sup>th</sup> Avenue East	20 <sup>th</sup> Street East	23 <sup>rd</sup> Street East
28 <sup>th</sup> Avenue East	8 <sup>th</sup> Street East	20 <sup>th</sup> Street East
East Bay Shore Road	3 <sup>rd</sup> Avenue East	36 <sup>th</sup> Street East
6 <sup>th</sup> Street East	3 <sup>rd</sup> Avenue East	9 <sup>th</sup> Avenue East
8 <sup>th</sup> Street East	9 <sup>th</sup> Avenue East	28 <sup>th</sup> Avenue East
10 <sup>th</sup> Street East/West	9 <sup>th</sup> Avenue East	Westerly City Limits
15 <sup>th</sup> Street East	3 <sup>rd</sup> Avenue East	9 <sup>th</sup> Avenue East
16 <sup>th</sup> Street East	6 <sup>th</sup> Avenue East	14 <sup>th</sup> Avenue East
17 <sup>th</sup> Street East	12 <sup>th</sup> Avenue East	Easterly City Limits
20 <sup>th</sup> Street East	9 <sup>th</sup> Avenue East	28 <sup>th</sup> Avenue East
23 <sup>rd</sup> Street East	16 <sup>th</sup> Avenue East	14 <sup>th</sup> Avenue East
28 <sup>th</sup> Street East	3 <sup>rd</sup> Avenue East	9 <sup>th</sup> Avenue East
32 <sup>nd</sup> Street East	East Bay Shore Road	9 <sup>th</sup> Avenue East
1 <sup>st</sup> Avenue West	10 <sup>th</sup> Street West	14 <sup>th</sup> Street West
2 <sup>nd</sup> Avenue West	10 <sup>th</sup> Street West	29 <sup>th</sup> Street West

14 <sup>th</sup> Street West	1 <sup>st</sup> Avenue West	Alpha Street
Alpha Street	10 <sup>th</sup> Street West	14 <sup>th</sup> Street West

SCHEDULE 11 D –HEAVY VEHICLE ROUTE TOUR BUS EXCEPTIONS			
Column 1	Column 2		Column 3
Highway	From	To	Time
5 <sup>th</sup> Street East	2 <sup>nd</sup> Avenue East	The Sydenham Circle	10 am to 4 pm
5 <sup>th</sup> Street ‘A’ East	2 <sup>nd</sup> Avenue East	The Sydenham Circle	10 am to 4 pm
Sydenham Circle	5 <sup>th</sup> Street East	5 <sup>th</sup> Street ‘A’ East	10 am to 4 pm
8 <sup>th</sup> Street East	1 <sup>st</sup> Avenue East	3 <sup>rd</sup> Avenue East	9 am to 1 am
1 <sup>st</sup> Avenue East	7 <sup>th</sup> Street East	8 <sup>th</sup> Street East	9 am to 1 am
7 <sup>th</sup> Street East	1 <sup>st</sup> Avenue East	2 <sup>nd</sup> Avenue East	9 am to 1 am
2 <sup>nd</sup> Avenue East	6 <sup>th</sup> Street East	7 <sup>th</sup> Street East	9 am to 1 am
6 <sup>th</sup> Street East	2 <sup>nd</sup> Avenue East	9 <sup>th</sup> Avenue East	9 am to 1 am

SCHEDULE 11E – NO HEAVY VEHICLE PARKING			
Column 1	Column 2	Column 3	
Highway	Side	From	To
2 <sup>nd</sup> Avenue East	Both	8 <sup>th</sup> Street East	10 <sup>th</sup> Street East
1 <sup>st</sup> Avenue West	East	8 <sup>th</sup> Street West	10 <sup>th</sup> Street West
2 <sup>nd</sup> Avenue West	Both	8 <sup>th</sup> Street West	10 <sup>th</sup> Street West

SCHEDULE “12” ONE WAY STREETS

SCHEDULE 12 – ONE WAY STREETS			
Column 1	Column 2	Column 3	
Highway	From	To	Direction
5 <sup>th</sup> Street “A” East	2 <sup>nd</sup> Avenue East	5 <sup>th</sup> Street East	South-westerly
1 <sup>st</sup> Avenue East	9 <sup>th</sup> Street East	8 <sup>th</sup> Street East	Southerly
	10 <sup>th</sup> Street East	A point 52 m north of the north curb face of 9 <sup>th</sup> Street East	Southerly
	A point 198 m south of the south curb face of 11 <sup>th</sup> Street East	10 <sup>th</sup> Street East	Southerly
1 <sup>st</sup> Avenue West	8 <sup>th</sup> Street West	9 <sup>th</sup> Street West	Northerly
3 <sup>rd</sup> Avenue West	15 <sup>th</sup> Street West	16 <sup>th</sup> Street West	Northerly
12 <sup>th</sup> Street West	4 <sup>th</sup> Avenue West	6 <sup>th</sup> Avenue West	Westerly
13 <sup>th</sup> Street West	4 <sup>th</sup> Avenue West	6 <sup>th</sup> Avenue West	Easterly
15 <sup>th</sup> Street West	4 <sup>th</sup> Avenue West	3 <sup>rd</sup> Avenue West	Easterly
Schedule 12 amended by By-law Nos. 2019-116 and 2021-051			

SCHEDULE “13” RATE OF SPEED IN CERTAIN AREAS

SCHEDULE 13A – RATE OF SPEED IN CERTAIN AREAS			
Column 1	Column 2	Column 3	
Highway	From	To	Rate of Speed
Harrison Park	Within Harrison Park		20 km/hr
	Entrance Road into Harrison Park		30 km/hr
1 <sup>st</sup> Avenue East	7 <sup>th</sup> Street East	11 <sup>th</sup> Street East	40 km/hr
2 <sup>nd</sup> Avenue East	7 <sup>th</sup> Street East	11 <sup>th</sup> Street East	40 km/hr
10 <sup>th</sup> Avenue East	10th Street East	15th Street A East	40 km/hr
11 <sup>th</sup> Avenue East	12th Street East	Cul-de-sac at the south end of 11th Avenue East	40 km/hr
12 <sup>th</sup> Avenue East	16th Street East	15th Street B East	40 km/hr
12 <sup>th</sup> Avenue East	12th Street East	11th Street East	40 km/hr
14 <sup>th</sup> Avenue East	15 <sup>th</sup> Steet B East	The southerly terminus	40 km/hr
15 <sup>th</sup> Avenue East	14 <sup>th</sup> Street East	The southerly terminus	40 km/hr
28 <sup>th</sup> Avenue East	8th Street East / Grey Road 5	Superior Street	60 km/hr
7 <sup>th</sup> Street East	1 <sup>st</sup> Avenue East	2 <sup>nd</sup> Avenue East	40 km/hr
10 <sup>th</sup> Street East	9th Avenue East	16th Avenue East	40 km/hr
11 <sup>th</sup> Street East	10th Avenue East	13th Avenue East	40 km/hr
11 <sup>th</sup> Street East	12th Avenue East	13th Avenue East	40 km/hr
12 <sup>th</sup> Street East	15th Street A East	12th Avenue East	40 km/hr
14 <sup>th</sup> Street East	14 <sup>th</sup> Avenue East	16 <sup>th</sup> Avenue East	40 km/hr
15 <sup>th</sup> Street A East	9 <sup>th</sup> Avenue East	10 <sup>th</sup> Avenue East	40 km/hr
15 <sup>th</sup> Street B East	15 <sup>th</sup> Avenue A East	14 <sup>th</sup> Avenue East	40 km/hr
16 <sup>th</sup> Street East	A point 125 m East of 18 <sup>th</sup> Ave East	a point 400 m east of 20th Ave East	60 km/hr
	a point 400 m east of 20th Ave East	The City Limits	80 km/hr
1 <sup>st</sup> Avenue West	8 <sup>th</sup> Street East	10 <sup>th</sup> Street East	40 km/hr
2 <sup>nd</sup> Avenue West	3rd Street A West	6th Street West	40 km/hr
6 <sup>th</sup> Avenue West	5th Street West	10th Street West	40 km/hr
3 <sup>rd</sup> Street A West	2nd Avenue West	2nd Avenue East	40 km/hr
4 <sup>th</sup> Street West	2nd Avenue West	2nd Avenue East	40 km/hr
5 <sup>th</sup> Street West	4th Avenue West	6th Avenue West	40 km/hr
8 <sup>th</sup> Street West	4th Avenue West	6th Avenue West	40 km/hr
9 <sup>th</sup> Street West	6th Avenue West	8th Avenue West	40 km/hr
10 <sup>th</sup> Street West	A point 107.9 m east of 6 <sup>th</sup> Avenue West	A point 110.3 m west of 6 <sup>th</sup> Avenue West	40 km/hr
14 <sup>th</sup> Street West	Alpha Street	The westerly limit of 14 <sup>th</sup> Street West	40 km/hr
Schedule 13A amended by By-law Nos. 2010-254, 2012-167, 2013-096, 2016-094, 2018-145, 2019-197, 2023-123			

SCHEDULE 13B – SCHOOL ZONES: 30 KM/HR on SCHOOL DAYS 8:00 AM – 5:00 PM			
Column 1	Column 2	Column 3	
School Name	Highway	From	To
Alexandra Community School	8 <sup>th</sup> Avenue East	15 <sup>th</sup> Street East	16 <sup>th</sup> Street East
	15 <sup>th</sup> Street A East	8 <sup>th</sup> Avenue East	9 <sup>th</sup> Avenue East
Ecole Catholique Saint-Dominique-Savio	8 <sup>th</sup> Avenue East	23 <sup>rd</sup> Street East	100 m south of 23 <sup>rd</sup> Street East
	23 <sup>rd</sup> Street East	8 <sup>th</sup> Avenue East	9 <sup>th</sup> Avenue East
Hillcrest Elementary School	4 <sup>th</sup> Avenue West	7 <sup>th</sup> Street West	8 <sup>th</sup> Street West
	6 <sup>th</sup> Avenue West	7 <sup>th</sup> Street West	8 <sup>th</sup> Street West
	8 <sup>th</sup> Street West	4 <sup>th</sup> Avenue West	6 <sup>th</sup> Avenue West
Keppel-Sarawak Elementary School	8 <sup>th</sup> Avenue West	24 <sup>th</sup> Street West	26 <sup>th</sup> Street West
	24 <sup>th</sup> Street West	120 m east of 8 <sup>th</sup> Avenue West	Town Limit
	24 <sup>th</sup> Street West	Town Limit	Carney Street (Georgian Bluffs)
	Finden Street (Georgian Bluffs)	24 <sup>th</sup> Street West	unopened road allowance of 26 <sup>th</sup> Street West
Notre Dame Catholic School	25 <sup>th</sup> Street East	9 <sup>th</sup> Avenue East	the westerly terminus
St. Basil Catholic Elementary School	9 <sup>th</sup> Avenue West	10 <sup>th</sup> Street West	the southerly terminus
Timothy Christian School	3 <sup>rd</sup> Avenue West	17 <sup>th</sup> Street West	100 m north of 17 <sup>th</sup> Street West
	4 <sup>th</sup> Avenue West	16 <sup>th</sup> Street West	19 <sup>th</sup> Street West
	17 <sup>th</sup> Street West	3 <sup>rd</sup> Avenue West	4 <sup>th</sup> Avenue West
Schedule 13B created by By-law No. 2023-092			

SCHEDULE “14” NO LEFT TURNS

SCHEDULE 14 – NO LEFT TURNS		
Column 1	Column 2	Column 3
Intersection	Direction	Time
1 <sup>st</sup> Avenue West and 10 <sup>th</sup> Street West	Westbound	At all times
4 <sup>th</sup> Avenue West and 10 <sup>th</sup> Street West	Eastbound	At all times
1 <sup>st</sup> Avenue East and 10 <sup>th</sup> Street East	East or West	At all times
5 <sup>th</sup> Avenue East and 10 <sup>th</sup> Street East	Westbound	At all times
8 <sup>th</sup> Avenue East and 10 <sup>th</sup> Street East	Northbound	At all times
9 <sup>th</sup> Avenue East and 15 <sup>th</sup> Street East	Eastbound	At all times
	Northbound	At all times
Schedule 14 amended by By-law Nos. 2016-123, 2019-172 and 2021-051		



SCHEDULE “15” RIGHT TURNS ONLY

SCHEDULE 15 – RIGHT TURNS ONLY		
Column 1	Column 2	Column 3
Highway	Direction	Time
1 <sup>st</sup> Avenue East and 10 <sup>th</sup> Street East	Southerly on 1 <sup>st</sup> Avenue East	At all times

SCHEDULE “16” NO U TURNS

SCHEDULE 16 – NO U TURNS			
Location			
That area bounded on the south by 6 <sup>th</sup> Street East, on the north by 11 <sup>th</sup> Street East, on the east by 3 <sup>rd</sup> Avenue East, on the west by 1 <sup>st</sup> Avenue East			
Column 1 Highway	Column 2 Vehicle Direction	Column 3 From	Column 4 To
9 <sup>th</sup> Avenue East	Southbound	10 <sup>th</sup> Street East	8 <sup>th</sup> Street East
Schedule 16 amended by By-law No. 2011-233			

**SCHEDULE "17" PARKING FEES**

➔ *Schedule 17 repealed by By-law 2019-060.*

**SCHEDULE “18” MUNICIPAL PARKING LOTS – METERS PROVIDED**

➔ *Schedule 18 repealed by By-law 2019-060.*

**SCHEDULE “19” MUNICIPAL PARKING LOTS - PAY AND DISPLAY MACHINES PROVIDED**

➔ *Schedule 19 repealed by By-law 2019-060.*

SCHEDULE "20" EMERGENCY PARKING FOR STORM STAYED MOTORISTS

SCHEDULE 20 – EMERGENCY PARKING  
FOR STORM STAYED MOTORISTS

10 parking spaces as outlined on the attached sketch within the **3<sup>rd</sup> Avenue East Parking Lot between 8<sup>th</sup> Street East and 9<sup>th</sup> Street East**

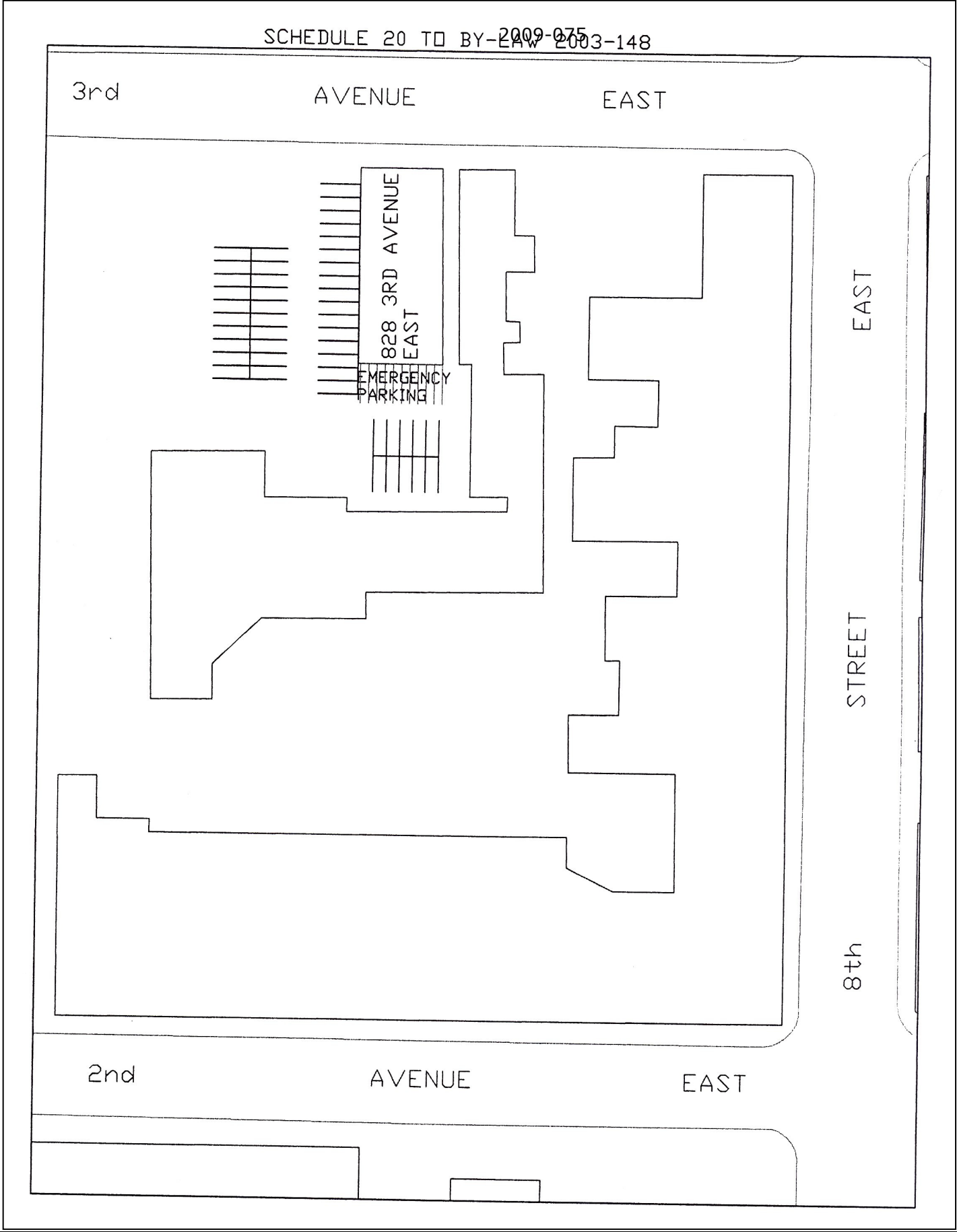

SCHEDULE "21" LOADING AND UNLOADING

SCHEDULE 21A – LOADING AND UNLOADING AT ALL TIMES			
Column 1	Column 2	Column 3	
Highway	Side(s)	From	To
1 <sup>st</sup> Avenue East	East	A point 11 m north of the north curb face of 10 <sup>th</sup> Street East	A point 7 m northerly
	East	A point 91 m north of the north curb face of 10 <sup>th</sup> Street East	A point 27 m northerly
	East	A point 40 m from the south curb face of 9 <sup>th</sup> Street East	A point 52 m southerly
2 <sup>nd</sup> Avenue East	West	A point 70.7 m north of the north curb face of 5 <sup>th</sup> Street A East	A point 30 m northerly
	West	A point 31 m south of the south curb face of 8 <sup>th</sup> Street East	A point 7 m southerly
	East	A point 30.6 m south of the south curb face of 8 <sup>th</sup> Street East	A point 7 m southerly
3 <sup>rd</sup> Avenue East	East	North of the north curb face of 6 <sup>th</sup> Street East	A point 12.2 m northerly
	East	A point 44.5 m south of the south curb face of 9 <sup>th</sup> Street East	A point 7 m southerly
	West	A point 57.0 m north of the north curb face of 10 <sup>th</sup> Street East	A point 12.8 m northerly
	West	A point 46.5 m north of the north curb face of 17 <sup>th</sup> Street East	A point 7 m northerly
4 <sup>th</sup> Avenue East	East	A point 77.0 m north of the projected curb face of 10 <sup>th</sup> Street East	A point 7.9 m northerly
8 <sup>th</sup> Street East	South	A point 60.3 m east of the east curb face of 2 <sup>nd</sup> Avenue East	A point 6 m easterly
	South	A point 29 m west of the west curb face of 2 <sup>nd</sup> Avenue East	A point 7.5 m westerly
	North	A point 24 m east of the east curb face of 2 <sup>nd</sup> Avenue East	A point 6 m easterly
	North	A point 23.8 m east of the east curb face of 3 <sup>rd</sup> Avenue East	A point 6.1 m easterly
	North	A point 20 m west of the west curb face of 3 <sup>rd</sup> Avenue East	A point 7 m westerly
9 <sup>th</sup> Street East	South	A point 56.9 m west of the west curb face of 3 <sup>rd</sup> Avenue East	A point 6.9 m westerly
	North	A point 6 m west of the west curb face of 1 <sup>st</sup> Avenue East	A point 9.5 m westerly
	North	A point 26.5 m west of the west curb face of 2 <sup>nd</sup> Avenue East	A point 9.5 m westerly
	North	A point 21.9 m west of the west curb face of 3 <sup>rd</sup> Avenue East	A point 6.7 m westerly
2 <sup>nd</sup> Avenue West	West	A point 28.3 m south of the south curb face of 8 <sup>th</sup> Street East	A point 6.15 m southerly
3 <sup>rd</sup> Avenue West	West	A point 44.2 m north of the north curb face of 10 <sup>th</sup> Street West	A point 24.4 m northerly
Lot 1 – 8 <sup>th</sup> Street East adjacent to City Hall	East	The northwest corner of City Hall at 808 2 <sup>nd</sup> Avenue East	A point 6 m northerly
Schedule 21 amended by By-law Nos. 2009-211, 2010-095, 2011-130, 2017-177, 2019-172, 2019-197, 2021-051 and 2022-108			

SCHEDULE 21B – LOADING AND UNLOADING BETWEEN 6:00 A.M. AND 6:00 P.M.			
Column 1	Column 2	Column 3	
Highway	Side(s)	From	To
9 <sup>th</sup> Street East	North	West curb face of 4 <sup>th</sup> Avenue East	A point 20.6 m westerly

SCHEDULE 21C – LOADING AND UNLOADING FOR VEHICLE DELIVERY ONLY to the Business Located at 229 10 <sup>th</sup> Street East Between 9:00 a.m. and 11:30 a.m. and 1:30 p.m. and 3:00 p.m. Twenty (20) Minutes Maximum Monday to Friday			
Column 1 Highway	Column 2 Side(s)	Column 3	
		From	To
1 <sup>st</sup> Avenue East	East	A point 68.0 m north of the north curb face of t9th Street East	A point 80.0 m northerly
10 <sup>th</sup> Street East	South	A point 38.1 m east of the east curb face of 2 <sup>nd</sup> Avenue East	A point 24.4 m easterly

SCHEDULE 21D – TOUR BUS LOADING AND UNLOADING			
Column 1 Highway	Column 2 Side(s)	Column 3	
		From	To
8 <sup>th</sup> Street East	North	22.3 m west of the west curb face of 2 <sup>nd</sup> Avenue East	A point 12.7 m westerly

SCHEDULE 21E – BUS LOADING AND UNLOADING 9:00 A.M. TO 4:00 P.M. MONDAY TO FRIDAY SEPTEMBER TO JUNE			
Column 1 Highway	Column 2 Side(s)	Column 3	
		From	To
3 <sup>rd</sup> Avenue West	West	A point 94 metres south of the south curb face of 10 <sup>th</sup> Street West	A point 13 metres southerly



SCHEDULE “22” SCHOOL BUS LOADING AND UNLOADING ZONE

SCHEDULE 22 – SCHOOL BUS LOADING AND UNLOADING ZONE			
Column 1	Column 2	Column 3	
Highway	Side(s)	From	To
Bayview School 6 <sup>th</sup> Street A East	South	A point 198.1 m west of the west curb face of 7 <sup>th</sup> Avenue East	A point 45.7 m northerly
Alexandra School 15 <sup>th</sup> Street East	North	A point 19.6 m east of the east curb face of 7 <sup>th</sup> Avenue East	A point 24.4 m westerly
Owen Sound Family Y 2 <sup>nd</sup> Avenue East	West	A point 47.7 m north of the north curb face of 5 <sup>th</sup> Street A East	A point 23 m northerly
Strathcona School 4 <sup>th</sup> Avenue East	East	A point 11.9 m north of the north curb face of 12 <sup>th</sup> Street East	A point 109.7 m northerly
Hillcrest School 8 <sup>th</sup> Street West	South	A point 24 m east of the east curb face of 5 <sup>th</sup> Avenue West	A point 12 m easterly
	South	A point 55.2 m east of the east curb face of 6 <sup>th</sup> Avenue West	A point 148.7 m easterly
Owen Sound District Secondary School 9 <sup>th</sup> Street West	North	A point 130 metres east of 8 <sup>th</sup> Avenue West	A point 155 metres west of 7 <sup>th</sup> Avenue West
Dufferin School 3 <sup>rd</sup> Avenue West	East	A point 65.8 m north of the north curb face of 10 <sup>th</sup> Street West	A point 78.0 m northerly
Victoria School 3 <sup>rd</sup> Avenue West	East	A point 28.3 m north of the north curb face of 17 <sup>th</sup> Street West	A point 32 m southerly
	West	A point 13.4 m north of the north curb face of 17 <sup>th</sup> Street West	A point 54.9 m northerly
St. Basils School 9 <sup>th</sup> Avenue West	East	A point 178.6 m south of the south curb face of 10 <sup>th</sup> Street West	A point 45.7 m southerly
Schedule 22 is amended by By-law No. 2019-116			

SCHEDULE “23” ACCESSIBLE PARKING SPACES

SCHEDULE 23 – ACCESSIBLE PARKING SPACES	
Column 1	Column 2
Location	Description
1 <sup>st</sup> Avenue East, West Side	One parking space 8 m southerly from the south curb face of 9 <sup>th</sup> Street East to a point 5 m southerly
	One parking space immediately south of 12 <sup>th</sup> Street East
2 <sup>nd</sup> Avenue East, East Side	One parking space 90 m north of the north curb face of 7 <sup>th</sup> Street East to a point 6 m northerly
	One parking space 93 m south of the south curb face of 9 <sup>th</sup> Street East to a point 10 m southerly
	One parking space 99 m south of the south curb face of 10 <sup>th</sup> Street East to a point 7 m southerly
	One parking space 96 m north of the north curb face of 10 <sup>th</sup> Street East to a point 7 m northerly
	One parking space 29.7 m south of the south curb face of 9 <sup>th</sup> street East to a point 36.5 m southerly
	One parking space 23.8 m north of the north curb face of 9 <sup>th</sup> Street East to a point 29.2 m northerly
2 <sup>nd</sup> Avenue East, West Side	One parking space 94 m north of projection of north curb face of 5 <sup>th</sup> Street A east to a point 7 m northerly
	One parking space 12 m north of the north curb face of 7 <sup>th</sup> Street East to a point 6.8 m northerly
	One parking space 24 m north of the north curb face of 9 <sup>th</sup> Street East to a point 7 m northerly
	One parking space 123 m north of the north curb face of 10 <sup>th</sup> Street East to a point 7 m northerly
3 <sup>rd</sup> Avenue East, Parking Lot No. 3, West Side Between 10 <sup>th</sup> Street East and 11 <sup>th</sup> Street East	One parking space 22.6 m north of 10 <sup>th</sup> Street East with a depth of 5 m commencing 4.75 m west of the west curb face of 3 <sup>rd</sup> Avenue East continuing 4.5 m westerly
3 <sup>rd</sup> Avenue East, Parking Lot No. 5, West Side, Between 8 <sup>th</sup> Street East and 9 <sup>th</sup> Street East	Two parking spaces side by side 95 m north of 8 <sup>th</sup> Street East and 67 m west of the west curb face of 3 <sup>rd</sup> Avenue East
3 <sup>rd</sup> Avenue East, parking Lot No. 4, West Side, Between 9 <sup>th</sup> Street East and 10 <sup>th</sup> Street East	One parking space 42.5 m south of the south curb face of 10 <sup>th</sup> Street East and 41 m west of 3 <sup>rd</sup> Avenue East
	Second parking space 83 m south of the south curb face of 10 <sup>th</sup> Street East and 75.5 m west of the west curb face of 3 <sup>rd</sup> Avenue East
3 <sup>rd</sup> Avenue East, West Side	One parking space 19 m south of the south curb face of 8 <sup>th</sup> Street East to a point 6.5 m southerly
	One parking space 65 m north of the north curb face of 17 <sup>th</sup> Street East to a point 6.5 m northerly
4 <sup>th</sup> Avenue East, West Side	One parking space 12 m south of the south curb face of 9 <sup>th</sup> Street East to a point 8 m southerly
5 <sup>th</sup> Avenue East, East Side	One parking space 89.0 m north of the projected north curb face of 10 <sup>th</sup> Street East to a point 7.5 m northerly
8 <sup>th</sup> Street East, South Side	One parking space 59.6 m west of the west curb face of 3 <sup>rd</sup> Avenue East to a point 6 m westerly
Municipal Parking Lot 1 - Behind City Hall, North Side of 8 <sup>th</sup> Street East	One parking space with a depth of 6 m from a point 41.2 m from the north curb face of 8 <sup>th</sup> Street East, west of 2 <sup>nd</sup> Avenue East to a point 44.6 m northerly
	One parking space in the front row of parking west of the City Hall a distance of 3.4 m wide and 5.4 m deep
1 <sup>st</sup> Avenue West, East Side	Two parking spaces 54.9 m south of the south curb face of 9 <sup>th</sup> Street West to a point 6.1 m southerly
	One parking space 33.5 m north of the projected north curb face of 8 <sup>th</sup> Street West to a point 4 m northerly
	One parking space 37.5 m north of the projected north curb face of 8 <sup>th</sup> Street West to a point 41.8 m northerly
9 <sup>th</sup> Street East, North Side	One parking space 23.5 m east of the projected east curb face of 3 <sup>rd</sup> Avenue East to a point 6.4 m easterly
9 <sup>th</sup> Street East, South side	One parking space 47 m west of the west projected curbface of 2 <sup>nd</sup> Avenue East to a point 5.4 m westerly

SCHEDULE 23 – ACCESSIBLE PARKING SPACES	
Column 1	Column 2
Location	Description
Municipal Parking Lot 9 - East Side of 1 <sup>st</sup> Avenue East between 7 <sup>th</sup> Street East and 8 <sup>th</sup> Street East	One parking space 32.3 m from the east curb face of 1 <sup>st</sup> Avenue East
Municipal Parking Lot 2 – East Side of 1 <sup>st</sup> Avenue West between 9 <sup>th</sup> Street West and 10 <sup>th</sup> Street West	North curb face of 9 <sup>th</sup> Street West to a point 208 m northerly
9 <sup>th</sup> Street West	Commencing from a point 33 m from the north curb face of 9 <sup>th</sup> Street West to a point 149.7 m northerly
Schedule 23 is amended by By-law Nos. 2010-039, 2011-130, 2018-161, 2020-003 and 2022-108	

SCHEDULE “24” CHILD CARE CENTRE LOADING AND UNLOADING ZONE

SCHEDULE 24 – CHILD CARE CENTRE LOADING AND UNLOADING ZONE Not to Exceed 10 Minutes			
Column 1	Column 2	Column 3	
Highway	Side(s)	From	To
Bruce-Grey Children’s Centre 2 <sup>nd</sup> Avenue East	East	A point 73.2 m south of the south curb face of 12 <sup>th</sup> Street East	A point 13.7 m southerly
M’ikwedong Native Cultural Centre 8 <sup>th</sup> Avenue East	East	A point 47.5 m north of the north curb face of 17 <sup>th</sup> Street East	A point 16 m northerly

SCHEDULE “25” YIELD RIGHT OF WAY

SCHEDULE 25 – YIELD RIGHT OF WAY	
Column 1	Column 2
Intersection	Description
Municipal parking Lot No. 1 and 1 <sup>st</sup> Avenue East	Northwest corner of Municipal Parking Lot No. 1
1 <sup>st</sup> Street East and 5 <sup>th</sup> Avenue East	Northwest corner
1 <sup>st</sup> Street East and 7 <sup>th</sup> Avenue East	Southwest corner
5 <sup>th</sup> Street A East and 5 <sup>th</sup> Street East	Northwest corner
South Side of 6 <sup>th</sup> Street East, West of 9 <sup>th</sup> Avenue East	Eastbound right turn lane on 6 <sup>th</sup> Street East at 9 <sup>th</sup> Avenue East
South Side of 10 <sup>th</sup> Street East, west of 9 <sup>th</sup> Avenue East	Eastbound right turn lane on 10 <sup>th</sup> Street East at 9 <sup>th</sup> Avenue East
17 <sup>th</sup> Street East at the harbour immediately adjacent to the Federal lands	Northeast corner
West Side of 9 <sup>th</sup> Avenue East, north of 10 <sup>th</sup> Street East	Southbound right turn lane on 9 <sup>th</sup> Avenue East at 10 <sup>th</sup> Street East
West Side of 28 <sup>th</sup> Avenue East, north of 8 <sup>th</sup> Street East	Southbound right turn lane on 28 <sup>th</sup> Avenue East at 8 <sup>th</sup> Street East
1 <sup>st</sup> Street West and 6 <sup>th</sup> Avenue West	Southwest corner
13 <sup>th</sup> Street A West and 6 <sup>th</sup> Avenue West	Northeast corner
2 <sup>nd</sup> Avenue West and Moore’s Hill	Northwest corner
5 <sup>th</sup> Avenue A West and 5 <sup>th</sup> Avenue West	Southwest corner
9 <sup>th</sup> Avenue West and 10 <sup>th</sup> Street West	Westbound right turn lane on 10 <sup>th</sup> Street West at 9 <sup>th</sup> Avenue West

SCHEDULE "26" THROUGH HIGHWAYS

SCHEDULE 26 – THROUGH HIGHWAYS	
Column 1	Column 2
Location	Description
Alpha Street	From the north limit of 14 <sup>th</sup> Street West to the east limit of 9 <sup>th</sup> Avenue West
East Bay Shore Road	From the east limit of 3 <sup>rd</sup> Avenue East to the south limit of 36 <sup>th</sup> Street East
Eddie Sargent Parkway	From the Pottawatomie River to the south limit of 19 <sup>th</sup> Street West
	From the north limit of 19 <sup>th</sup> Street West to the south limit of 22 <sup>nd</sup> Street West
1 <sup>st</sup> Avenue East	From the northerly limit of 10 <sup>th</sup> Street East to the southerly limit of 13 <sup>th</sup> Street East
2 <sup>nd</sup> Avenue East	From the southerly City Limit to the southerly limit of 6 <sup>th</sup> Street East
	From the pedestrian crossover midway of 1000 block to the southerly limit of 18 <sup>th</sup> Street East
3 <sup>rd</sup> Avenue East	From north limit of 6 <sup>th</sup> Street East to the south limit of 8 <sup>th</sup> Street East
	From the north limit of 10 <sup>th</sup> Street East to south of the East Bay Shore Road
4 <sup>th</sup> Avenue East	From the north limit of 10 <sup>th</sup> Street East to the south limit of 15 <sup>th</sup> Street East
	From the north limit of 5 <sup>th</sup> Street East to the south limit of 8 <sup>th</sup> Street East
	From the north limit of 15 <sup>th</sup> Street East to the south limit of 18 <sup>th</sup> Street East
5 <sup>th</sup> Avenue East	From the north limit of 16 <sup>th</sup> Street East to the north limit of 5 <sup>th</sup> Avenue East
6 <sup>th</sup> Avenue East	From the north limit of 16 <sup>th</sup> Street East to the south limit of 20 <sup>th</sup> Street East
7 <sup>th</sup> Avenue East	From the south limit of 6 <sup>th</sup> Street East to the south City Limits
	From the north limit of 6 <sup>th</sup> Street East to the south limit of 8 <sup>th</sup> Street East
	From the north limit of 8 <sup>th</sup> Street East to the south limit of 10 <sup>th</sup> Street East
	From the north limit of 16 <sup>th</sup> Street East to the south limit of 20 <sup>th</sup> Street East
8 <sup>th</sup> Avenue East	From the north limit of 6 <sup>th</sup> Street East to the south limit of 8 <sup>th</sup> Street East
	From the north limit of 8 <sup>th</sup> Street East to the south limit of 10 <sup>th</sup> Street East
	From the north limit of 16 <sup>th</sup> Street East to the south limit of 18 <sup>th</sup> Street East
	From the north limit of 20 <sup>th</sup> Street East to the south limit of 23 <sup>rd</sup> Street East
9 <sup>th</sup> Avenue East	From the south limits of the City to the south limit of 6 <sup>th</sup> Street East
	From the north limit of 6 <sup>th</sup> Street East to the south limit of 8 <sup>th</sup> Street East
	From the north limit of 8 <sup>th</sup> Street East to the south limit of 10 <sup>th</sup> Street East
	From the north limit of 10 <sup>th</sup> Street East to the south limit of 16 <sup>th</sup> Street East
	From the north limit of 16 <sup>th</sup> Street East to the south limit of 20 <sup>th</sup> Street East
	From the north limit of 20 <sup>th</sup> Street East to the north limit of 28 <sup>th</sup> Street East
16 <sup>th</sup> Avenue East	From the north limit of 8 <sup>th</sup> Street East to the south limit of 16 <sup>th</sup> Street East
	From the north limit of 16 <sup>th</sup> Street East to the south limit of 20 <sup>th</sup> Street East

SCHEDULE 26 – THROUGH HIGHWAYS	
Column 1	Column 2
Location	Description
	From the north limit of 20 <sup>th</sup> Street East to the south limit of 23 <sup>rd</sup> Street East
28 <sup>th</sup> Avenue East	From the south limit of 4 <sup>th</sup> Street East (Superior Street) to the north limit of 26 <sup>th</sup> Street East
	From the north limit of 16 <sup>th</sup> Street East to the south limit of 26 <sup>th</sup> Street East
4 <sup>th</sup> Street East	From the east limit of 8 <sup>th</sup> Avenue B East to the east limit of 7 <sup>th</sup> Avenue East
	From the east limit of 9 <sup>th</sup> Avenue B East to the west limit of 28 <sup>th</sup> Avenue East
6 <sup>th</sup> Street East	From the east limit of 2 <sup>nd</sup> Avenue east to the west limit of 7 <sup>th</sup> Avenue East
	From the east limit of 7 <sup>th</sup> Avenue East to the west limit of 9 <sup>th</sup> Avenue East
8 <sup>th</sup> Street East	From the east limit of 3 <sup>rd</sup> Avenue East to the West limit of 7 <sup>th</sup> Avenue East
	From the east limit of 7 <sup>th</sup> Avenue East to the west limit of 9 <sup>th</sup> Avenue East
	From the east limit of 9 <sup>th</sup> Avenue East to the west limit of 16 <sup>th</sup> Avenue East
	From the east limit of 16 <sup>th</sup> Avenue East to the west limit of 28 <sup>th</sup> Avenue East
10 <sup>th</sup> Street East	From the east limit of 4 <sup>th</sup> Avenue East to the west limit of 9 <sup>th</sup> Avenue East
	From the east limit of 9 <sup>th</sup> Avenue East to the west limit of Lamson Crescent
15 <sup>th</sup> Street East	From the east limit of 3 <sup>rd</sup> Avenue East to the west limit of 6 <sup>th</sup> Avenue East
	From the east limit of 6 <sup>th</sup> Avenue East to the west limit of 9 <sup>th</sup> Avenue East
16 <sup>th</sup> Street East	From the east limit of 6 <sup>th</sup> Avenue East to the west limit of 9 <sup>th</sup> Avenue East
	From the east limit of 19 <sup>th</sup> Avenue East to the East City Limits
20 <sup>th</sup> Street East	From the east limit of 5 <sup>th</sup> Avenue East to the west limit of 9 <sup>th</sup> Avenue East
	From the east limit of 9 <sup>th</sup> Avenue East to the west limit of 29 <sup>th</sup> Avenue East
	From the east limit of 9 <sup>th</sup> Avenue East to the east City Limits
26 <sup>th</sup> Street East	From the east limit of 9 <sup>th</sup> Avenue East to the east City Limits
1 <sup>st</sup> Avenue West	From the north limit of 10 <sup>th</sup> Street West to the south limit of 14 <sup>th</sup> Street West
2 <sup>nd</sup> Avenue West	From the east limit of 4 <sup>th</sup> Street West to the south limit of Moore’s Hill
	From the north limit of Moore’s Hill to the south limit of 8 <sup>th</sup> Street West
	From the north limit of 10 <sup>th</sup> Street West to the south limit of 14 <sup>th</sup> Street West
	From the north limit of 14 <sup>th</sup> Street West to the Pottawatommi River
3 <sup>rd</sup> Avenue West	From the northerly limit of 22 <sup>nd</sup> Street West to the northerly limit of the City
4 <sup>th</sup> Avenue West	From the southerly limit of the City to the south limit of 2 <sup>nd</sup> Street West
	From the north limit of 2 <sup>nd</sup> Street West to the south limit of Moore’s Hill

SCHEDULE 26 – THROUGH HIGHWAYS	
Column 1	Column 2
Location	Description
	From the north limit of Moore’s Hill to the north limit of 8 <sup>th</sup> Street West
	From the north limit of 10 <sup>th</sup> Street West to the south limit of 14 <sup>th</sup> Street West
	From the north limit of 14 <sup>th</sup> Street West to the south limit of 17 <sup>th</sup> Street West at the pedestrian crossover
	From the north limit of 17 <sup>th</sup> Street West to the south limit of 19 <sup>th</sup> Street West
	From the north limit of 19 <sup>th</sup> Street West to the south limit of 23 <sup>rd</sup> Street West
	From the north limit of 23 <sup>rd</sup> Street West to the north limit of 24 <sup>th</sup> Street West
6 <sup>th</sup> Avenue West	From the south limit of 1 <sup>st</sup> Street West to the south limit of 8 <sup>th</sup> Street West
	From the north limit of 10 <sup>th</sup> Street West to the north limit of 11 <sup>th</sup> Street A West
	From the south limit of 12 <sup>th</sup> Street West to the south west limit of Alpha Street
8 <sup>th</sup> Avenue West	From the north limit of 16 <sup>th</sup> Street West to the south limit of 20 <sup>th</sup> Street West
	From the south limit of 23 <sup>rd</sup> Street West to the south limit of 27 <sup>th</sup> Street West
5 <sup>th</sup> Street West	From the west limit of 4 <sup>th</sup> Avenue West to the east limit of 6 <sup>th</sup> Avenue West
7 <sup>th</sup> Street West	From the west limit of 4 <sup>th</sup> Avenue West to the east limit of 6 <sup>th</sup> Avenue West
8 <sup>th</sup> Street West	From the east limit of 4 <sup>th</sup> Avenue West to the east limit of 5 <sup>th</sup> Avenue West
9 <sup>th</sup> Street West	From the west limit of 6 <sup>th</sup> Avenue West to the east limit of 8 <sup>th</sup> Avenue West
10 <sup>th</sup> Street West	From the west limit of 4 <sup>th</sup> Avenue West to the east limit of 7 <sup>th</sup> Avenue West
	From the west limit of 7 <sup>th</sup> Avenue West to the west City Limits
12 <sup>th</sup> Street West	From the west limit of 2 <sup>nd</sup> Avenue West to the east limit of 4 <sup>th</sup> Avenue West
13 <sup>th</sup> Street West	From the west limit of 2 <sup>nd</sup> Avenue West to the east limit of 4 <sup>th</sup> Avenue West
14 <sup>th</sup> Street West	From the west limit of Alpha Street to the west City Limits
15 <sup>th</sup> Street West	From the west limit of 4 <sup>th</sup> Avenue West to the west limit of 7 <sup>th</sup> Avenue West
16 <sup>th</sup> Street West	From the west limit of 4 <sup>th</sup> Avenue West to the westerly limit of the City
19 <sup>th</sup> Street West	From the Eddie Sargent Parkway to the east limit of 4 <sup>th</sup> Avenue West
	From the west limit of 4 <sup>th</sup> Avenue West to the westerly limit of the City
20 <sup>th</sup> Street West	From the west limit of 4 <sup>th</sup> Avenue West to the westerly limit of the City
22 <sup>nd</sup> Street West	From the west limit of 4 <sup>th</sup> Avenue West to the east limit of 7 <sup>th</sup> Avenue West
23 <sup>rd</sup> Street West	From the west limit of 3 <sup>rd</sup> Avenue West to the westerly limit of the City
24 <sup>th</sup> Street West	From the west limit of 4 <sup>th</sup> Avenue West to the westerly limit of the City
26 <sup>th</sup> Street West	From the west limit of 3 <sup>rd</sup> Avenue West to the east limit of 8 <sup>th</sup> Avenue West
27 <sup>th</sup> Street West	From the west limit of 3 <sup>rd</sup> Avenue West to the westerly limit of the City



SCHEDULE 26 – THROUGH HIGHWAYS	
Column 1	Column 2
Location	Description
28 <sup>th</sup> Street West	From the west limit of 3 <sup>rd</sup> Avenue West to the east limit of 6 <sup>th</sup> Avenue West
29 <sup>th</sup> Street West	From the west limit of 3 <sup>rd</sup> Avenue West to the west limit of 6 <sup>th</sup> Avenue West
Schedule 26 is amended by By-law Nos. 2014-068 and 2021-107	

SCHEDULE “27” STOP SIGNS

SCHEDULE 27 – STOP SIGNS		
Column 1	Column 2	Column 3
Highway	Vehicle Direction	Intersection
1 <sup>st</sup> Avenue East	North	8 <sup>th</sup> Street East
	South	9 <sup>th</sup> Street East
	North	9 <sup>th</sup> Street East
2 <sup>nd</sup> Avenue East	North	18 <sup>th</sup> Street East
	South	18 <sup>th</sup> Street East
Rear 2 <sup>nd</sup> Avenue East	East	2 <sup>nd</sup> Avenue East
3 <sup>rd</sup> Avenue East	South	5 <sup>th</sup> Street East
4 <sup>th</sup> Avenue East	Both	5 <sup>th</sup> Street East
	Both	6 <sup>th</sup> Street East
	Both	8 <sup>th</sup> Street East
	North	15 <sup>th</sup> Street East
5 <sup>th</sup> Avenue East	South	5 <sup>th</sup> Street East
	South	1 <sup>st</sup> Street East
	North	6 <sup>th</sup> Street East
	South	7 <sup>th</sup> Street East
	North	8 <sup>th</sup> Street East
	South	8 <sup>th</sup> Street East
	North	10 <sup>th</sup> Street East
	West	17 <sup>th</sup> Street East
	West	18 <sup>th</sup> Street East
	West	18 <sup>th</sup> Street A East
	West	19 <sup>th</sup> Street East
5 <sup>th</sup> Avenue A East	Southbound	9 <sup>th</sup> Street East
7 <sup>th</sup> Avenue East	North	1 <sup>st</sup> Street East
	North	10 <sup>th</sup> Street East
	North	15 <sup>th</sup> Street East
	South	15 <sup>th</sup> Street East
	North	16 <sup>th</sup> Street East
	South	16 <sup>th</sup> Street East
	North	20 <sup>th</sup> Street East
	South	20 <sup>th</sup> Street East
8 <sup>th</sup> Avenue East	North	4 <sup>th</sup> Street East
	South	4 <sup>th</sup> Street East
	South	6 <sup>th</sup> Street East
	North	7 <sup>th</sup> Street East
	North	8 <sup>th</sup> Street East
	South	8 <sup>th</sup> Street East
	South	10 <sup>th</sup> Street East
	North	15 <sup>th</sup> Street East
	South	15 <sup>th</sup> Street East
	North	16 <sup>th</sup> Street East
	South	16 <sup>th</sup> Street East
	South	19 <sup>th</sup> Street East
	North	20 <sup>th</sup> Street East
	South	20 <sup>th</sup> Street East
	North	23 <sup>rd</sup> Street East
	South	25 <sup>th</sup> Street East
8 <sup>th</sup> Avenue A East	North	4 <sup>th</sup> Street East
	North	5 <sup>th</sup> Street East
	West	8 <sup>th</sup> Avenue East
	South	8 <sup>th</sup> Avenue East
	South	9 <sup>th</sup> Street East
8 <sup>th</sup> Avenue B East	North	4 <sup>th</sup> Street East
10 <sup>th</sup> Avenue East	South	8 <sup>th</sup> Street East
	North	10 <sup>th</sup> Street East
	South	10 <sup>th</sup> Street East
11 <sup>th</sup> Avenue East	South	8 <sup>th</sup> Street East
	North	10 <sup>th</sup> Street East
	North	12 <sup>th</sup> Street East

SCHEDULE 27 – STOP SIGNS		
Column 1	Column 2	Column 3
Highway	Vehicle Direction	Intersection
12 <sup>th</sup> Avenue East	South	15 <sup>th</sup> Street B East
14 <sup>th</sup> Avenue A East	North	14 <sup>th</sup> Street East
	South	14 <sup>th</sup> Street East
15 <sup>th</sup> Avenue East	North	14 <sup>th</sup> Street East
16 <sup>th</sup> Avenue East	North	20 <sup>th</sup> Street East
	South	20 <sup>th</sup> Street East
18 <sup>th</sup> Avenue East	North	17 <sup>th</sup> Street East
	North	23 <sup>rd</sup> Street East
20 <sup>th</sup> Avenue East	North	17 <sup>th</sup> Street East
	South	20 <sup>th</sup> Street East
28 <sup>th</sup> Avenue East	North	16 <sup>th</sup> Street East
	South	16 <sup>th</sup> Street East
1 <sup>st</sup> Street East	West	2 <sup>nd</sup> Avenue East
2 <sup>nd</sup> Street East	West	2 <sup>nd</sup> Avenue East
	East	7 <sup>th</sup> Avenue East
2 <sup>nd</sup> Street A East	West	7 <sup>th</sup> Avenue East
3 <sup>rd</sup> Street East	East	7 <sup>th</sup> Avenue East
4 <sup>th</sup> Street East	West	2 <sup>nd</sup> Avenue East
	East	7 <sup>th</sup> Avenue East
	West	7 <sup>th</sup> Avenue East
4 <sup>th</sup> Street A East	West	2 <sup>nd</sup> Avenue East
	East	7 <sup>th</sup> Avenue East
4 <sup>th</sup> Street B East	East	2 <sup>nd</sup> Avenue East
5 <sup>th</sup> Street East	West	2 <sup>nd</sup> Avenue East
	East	5 <sup>th</sup> Avenue East
	West	7 <sup>th</sup> Avenue East
6 <sup>th</sup> Street A East	West	7 <sup>th</sup> Avenue East
	West	8 <sup>th</sup> Avenue East
7 <sup>th</sup> Street East	East	2 <sup>nd</sup> Avenue East
	West	2 <sup>nd</sup> Avenue East
	East	3 <sup>rd</sup> Avenue East
	West	3 <sup>rd</sup> Avenue East
	East	4 <sup>th</sup> Avenue East
	West	4 <sup>th</sup> Avenue East
	East	7 <sup>th</sup> Avenue East
	West	7 <sup>th</sup> Avenue East
	East	8 <sup>th</sup> Avenue East
	West	8 <sup>th</sup> Avenue East
	East	9 <sup>th</sup> Avenue East
	West	9 <sup>th</sup> Avenue East
	East	9 <sup>th</sup> Avenue East
7 <sup>th</sup> Street A East	East	7 <sup>th</sup> Avenue East
	West	7 <sup>th</sup> Avenue East
	West	8 <sup>th</sup> Avenue East
8 <sup>th</sup> Street East	West	28 <sup>th</sup> Avenue East
8 <sup>th</sup> Street A East	West	5 <sup>th</sup> Avenue East
	West	7 <sup>th</sup> Avenue East
9 <sup>th</sup> Street East	East	7 <sup>th</sup> Avenue East
	West	7 <sup>th</sup> Avenue East
	East	8 <sup>th</sup> Avenue East
	West	8 <sup>th</sup> Avenue East
	East	9 <sup>th</sup> Avenue East
	East	9 <sup>th</sup> Avenue A East
9 <sup>th</sup> Street A East	East	7 <sup>th</sup> Avenue East
	East	8 <sup>th</sup> Avenue East
	West	8 <sup>th</sup> Avenue East
	West	5 <sup>th</sup> Avenue East
11 <sup>th</sup> Street East	West	1 <sup>st</sup> Avenue East
	East	2 <sup>nd</sup> Avenue East
	West	2 <sup>nd</sup> Avenue East
	East	3 <sup>rd</sup> Avenue East
	West	3 <sup>rd</sup> Avenue East

SCHEDULE 27 – STOP SIGNS		
Column 1	Column 2	Column 3
Highway	Vehicle Direction	Intersection
	East	4 <sup>th</sup> Avenue East
	West	1 <sup>st</sup> Avenue East
	East	2 <sup>nd</sup> Avenue East
	East	11 <sup>th</sup> Avenue East
12 <sup>th</sup> Street East	West	2 <sup>nd</sup> Avenue East
	East	3 <sup>rd</sup> Avenue East
	West	2 <sup>nd</sup> Avenue East
	East	3 <sup>rd</sup> Avenue East
	West	3 <sup>rd</sup> Avenue East
	East	4 <sup>th</sup> Avenue East
13 <sup>th</sup> Street East	East	2 <sup>nd</sup> Avenue East
	West	2 <sup>nd</sup> Avenue East
	East	3 <sup>rd</sup> Avenue East
	West	3 <sup>rd</sup> Avenue East
	East	4 <sup>th</sup> Avenue East
	West	4 <sup>th</sup> Avenue East
14 <sup>th</sup> Street East	West	2 <sup>nd</sup> Avenue East
	East	3 <sup>rd</sup> Avenue East
	West	3 <sup>rd</sup> Avenue East
	East	4 <sup>th</sup> Avenue East
	West	14 <sup>th</sup> Avenue East
	East	16 <sup>th</sup> Avenue East
15 <sup>th</sup> Street East	West	3 <sup>rd</sup> Avenue East
	West	6 <sup>th</sup> Avenue East
	Southeast	9 <sup>th</sup> Avenue East
15 <sup>th</sup> Street A East	West	8 <sup>th</sup> Avenue East
	East	9 <sup>th</sup> Avenue East
	West	9 <sup>th</sup> Avenue East
	East	10 <sup>th</sup> Avenue East
15 <sup>th</sup> Street B East	South	15 <sup>th</sup> Street A East
16 <sup>th</sup> Street East	West	3 <sup>rd</sup> Avenue East
	East	4 <sup>th</sup> Avenue East
	East	6 <sup>th</sup> Avenue East
17 <sup>th</sup> Street East	East	2 <sup>nd</sup> Avenue East
	West	2 <sup>nd</sup> Avenue East
	East	3 <sup>rd</sup> Avenue East
	West	3 <sup>rd</sup> Avenue East
	East	4 <sup>th</sup> Avenue East
	West	5 <sup>th</sup> Avenue East
	East	6 <sup>th</sup> Avenue East
	West	6 <sup>th</sup> Avenue East
	East	7 <sup>th</sup> Avenue East
	West	7 <sup>th</sup> Avenue East
	East	8 <sup>th</sup> Avenue East
	West	8 <sup>th</sup> Avenue East
	East	9 <sup>th</sup> Avenue East
	West	9 <sup>th</sup> Avenue East
18 <sup>th</sup> Street East	East	3 <sup>rd</sup> Avenue East
	West	3 <sup>rd</sup> Avenue East
	West	5 <sup>th</sup> Avenue East
	East	6 <sup>th</sup> Avenue East
	West	6 <sup>th</sup> Avenue East
	East	7 <sup>th</sup> Avenue East
	West	7 <sup>th</sup> Avenue East
	East	9 <sup>th</sup> Avenue East
18 <sup>th</sup> Street A East	West	5 <sup>th</sup> Avenue East
19 <sup>th</sup> Street East	West	5 <sup>th</sup> Avenue East
	East	6 <sup>th</sup> Avenue East
	West	6 <sup>th</sup> Avenue East
	East	7 <sup>th</sup> Avenue East
	West	7 <sup>th</sup> Avenue East

SCHEDULE 27 – STOP SIGNS		
Column 1	Column 2	Column 3
Highway	Vehicle Direction	Intersection
	East	8 <sup>th</sup> Avenue East
	West	8 <sup>th</sup> Avenue East
	East	9 <sup>th</sup> Avenue East
	West	9 <sup>th</sup> Avenue East
20 <sup>th</sup> Street East	West	5 <sup>th</sup> Avenue East
	East	28 <sup>th</sup> Avenue East
21 <sup>st</sup> Street East	East	8 <sup>th</sup> Avenue East
21 <sup>st</sup> Street A East	East	8 <sup>th</sup> Avenue East
23 <sup>rd</sup> Street East	East	9 <sup>th</sup> Avenue East
24 <sup>th</sup> Street East	West	3 <sup>rd</sup> Avenue East
25 <sup>th</sup> Street East	East	9 <sup>th</sup> Avenue East
25 <sup>th</sup> Street A East	East	9 <sup>th</sup> Avenue East
26 <sup>th</sup> Street East	East	9 <sup>th</sup> Avenue East
	West	9 <sup>th</sup> Avenue East
28 <sup>th</sup> Street East	West	3 <sup>rd</sup> Avenue East
	Southwest	3 <sup>rd</sup> Avenue East
32 <sup>nd</sup> Street East	West	3 <sup>rd</sup> Avenue East
1 <sup>st</sup> Avenue West	South	14 <sup>th</sup> Street West
1 <sup>st</sup> Avenue A West	North	11 <sup>th</sup> Street West
2 <sup>nd</sup> Avenue West	North	Beattie Street
	North	Moore’s Hill
2 <sup>nd</sup> Avenue A West	South	12 <sup>th</sup> Street West
	North	13 <sup>th</sup> Street West
3 <sup>rd</sup> Avenue West	North	Beattie Street
	North	8 <sup>th</sup> Street West
	South	8 <sup>th</sup> Street West
	North	12 <sup>th</sup> Street West
	North	17 <sup>th</sup> Street West
	South	17 <sup>th</sup> Street West
	North	19 <sup>th</sup> Street West
3 <sup>rd</sup> Avenue A West	North	8 <sup>th</sup> Street West
	South	12 <sup>th</sup> Street West
	North	13 <sup>th</sup> Street West
4 <sup>th</sup> Avenue West	North	Moore’s Hill
	South	Moore’s Hill
	North	2 <sup>nd</sup> Street West
	South	2 <sup>nd</sup> Street West
	North	10 <sup>th</sup> Street West
	South	10 <sup>th</sup> Street West
	South	15 <sup>th</sup> Street West
	North	28 <sup>th</sup> Street West
	South	28 <sup>th</sup> Street West
	North	29 <sup>th</sup> Street West
	South	29 <sup>th</sup> Street West
4 <sup>th</sup> Avenue A West	South	5 <sup>th</sup> Street West
	South	8 <sup>th</sup> Street West
5 <sup>th</sup> Avenue West	South	1 <sup>st</sup> Street West
	North	4 <sup>th</sup> Street West
	South	5 <sup>th</sup> Street West
	North	7 <sup>th</sup> Street West
	South	8 <sup>th</sup> Street West
	North	12 <sup>th</sup> Street West
	South	12 <sup>th</sup> Street West
	North	13 <sup>th</sup> Street West
	South	13 <sup>th</sup> Street West
	South	15 <sup>th</sup> Street West
	North	16 <sup>th</sup> Street West
	South	16 <sup>th</sup> Street West
	North	17 <sup>th</sup> Street West
	South	17 <sup>th</sup> Street West
	North	18 <sup>th</sup> Street West

SCHEDULE 27 – STOP SIGNS		
Column 1	Column 2	Column 3
Highway	Vehicle Direction	Intersection
	South	18 <sup>th</sup> Street West
	North	19 <sup>th</sup> Street West
	North	22 <sup>nd</sup> Street West
	South	22 <sup>nd</sup> Street West
	South	24 <sup>th</sup> Street West
	North	26 <sup>th</sup> Street West
	South	27 <sup>th</sup> Street West
	North	28 <sup>th</sup> Street West
5 <sup>th</sup> Avenue A West	North	2 <sup>nd</sup> Street A West
	North	5 <sup>th</sup> Street West
	South	5 <sup>th</sup> Street West
	North	7 <sup>th</sup> Street West
	South	9 <sup>th</sup> Street A West
	South	15 <sup>th</sup> Street West
6 <sup>th</sup> Avenue West	North	Alpha Street
	South	Alpha Street
	North	10 <sup>th</sup> Street West
	South	10 <sup>th</sup> Street West
	South	14 <sup>th</sup> Street West
	South	15 <sup>th</sup> Street West
	North	16 <sup>th</sup> Street West
	North	19 <sup>th</sup> Street West
	South	19 <sup>th</sup> Street West
	North	20 <sup>th</sup> Street West
	South	20 <sup>th</sup> Street West
	South	22 <sup>nd</sup> Street West
	North	23 <sup>rd</sup> Street West
	South	24 <sup>th</sup> Street West
	North	26 <sup>th</sup> Street West
7 <sup>th</sup> Avenue West	North	Alpha Street
	North	8 <sup>th</sup> Street West
	South	8 <sup>th</sup> Street West
	North	9 <sup>th</sup> Street West
	North	10 <sup>th</sup> Street West
	South	10 <sup>th</sup> Street West
	North	11 <sup>th</sup> Street West
	South	14 <sup>th</sup> Street West
	South	16 <sup>th</sup> Street West
	North	19 <sup>th</sup> Street West
	South	20 <sup>th</sup> Street West
	North	23 <sup>rd</sup> Street West
8 <sup>th</sup> Avenue West	South	Alpha Street
	South	16 <sup>th</sup> Street West
	North	19 <sup>th</sup> Street West
	South	19 <sup>th</sup> Street West
	North	20 <sup>th</sup> Street West
	North	27 <sup>th</sup> Street West
	South	27 <sup>th</sup> Street West
Alpha Street	West	9 <sup>th</sup> Street West
Beattie Street	West	4 <sup>th</sup> Avenue West
1 <sup>st</sup> Street West	East	4 <sup>th</sup> Avenue West
	West	4 <sup>th</sup> Avenue West
	West	6 <sup>th</sup> Avenue West
1 <sup>st</sup> Street A West	West	6 <sup>th</sup> Avenue West
1 <sup>st</sup> Street Southwest	West	4 <sup>th</sup> Avenue West
2 <sup>nd</sup> Street West	East	4 <sup>th</sup> Avenue West
	West	5 <sup>th</sup> Avenue West
2 <sup>nd</sup> Street A West	West	6 <sup>th</sup> Avenue West
3 <sup>rd</sup> Street West	East	2 <sup>nd</sup> Avenue West
	East	4 <sup>th</sup> Avenue West
3 <sup>rd</sup> Street A West	East	2 <sup>nd</sup> Avenue East

SCHEDULE 27 – STOP SIGNS		
Column 1	Column 2	Column 3
Highway	Vehicle Direction	Intersection
4 <sup>th</sup> Street West	West	5 <sup>th</sup> Avenue ‘A’ West
	East	2 <sup>nd</sup> Avenue East
	West	2 <sup>nd</sup> Avenue West
4 <sup>th</sup> Street A West	North	5 <sup>th</sup> Street West
5 <sup>th</sup> Street West	East	4 <sup>th</sup> Avenue West
5 <sup>th</sup> Street A West	South	5 <sup>th</sup> Street West
6 <sup>th</sup> Street West	West	2 <sup>nd</sup> Avenue West
	West	6 <sup>th</sup> Avenue West
7 <sup>th</sup> Street West	East	2 <sup>nd</sup> Avenue West
	East	4 <sup>th</sup> Avenue West
	East	6 <sup>th</sup> Avenue West
	West	6 <sup>th</sup> Avenue West
8 <sup>th</sup> Street West	East	3 <sup>rd</sup> Avenue West
	East	5 <sup>th</sup> Avenue West
	West	3 <sup>rd</sup> Avenue West – north leg
	West	5 <sup>th</sup> Avenue West
9 <sup>th</sup> Street West	West	8 <sup>th</sup> Avenue West
9 <sup>th</sup> Street A West	East	5 <sup>th</sup> Avenue West
	West	6 <sup>th</sup> Avenue West
10 <sup>th</sup> Street A West	West	6 <sup>th</sup> Avenue West
11 <sup>th</sup> Street West	West	Alpha Street
	East	1 <sup>st</sup> Avenue West
	East	2 <sup>nd</sup> Avenue West
	West	2 <sup>nd</sup> Avenue West
	East	4 <sup>th</sup> Avenue West
	West	4 <sup>th</sup> Avenue West
	East	6 <sup>th</sup> Avenue West
11 <sup>th</sup> Street A West	East	4 <sup>th</sup> Avenue West
	East	4 <sup>th</sup> Avenue West
	West	6 <sup>th</sup> Avenue West
11 <sup>th</sup> Street B West	East	4 <sup>th</sup> Avenue West
12 <sup>th</sup> Street West	West	Alpha Street
	East	1 <sup>st</sup> Avenue West
	East	2 <sup>nd</sup> Avenue West
	West	2 <sup>nd</sup> Avenue West
	West	4 <sup>th</sup> Avenue West
	West	6 <sup>th</sup> Avenue West
13 <sup>th</sup> Street West	East	1 <sup>st</sup> Avenue West
	East	2 <sup>nd</sup> Avenue West
	West	2 <sup>nd</sup> Avenue West
	East	4 <sup>th</sup> Avenue West
	West	4 <sup>th</sup> Avenue West
13 <sup>th</sup> Street A West	East	4 <sup>th</sup> Avenue West
15 <sup>th</sup> Street West	East	4 <sup>th</sup> Avenue West
16 <sup>th</sup> Street West	East	4 <sup>th</sup> Avenue West
	East	3 <sup>rd</sup> Avenue West
	West	4 <sup>th</sup> Avenue West
17 <sup>th</sup> Street West	East	3 <sup>rd</sup> Avenue West
	East	4 <sup>th</sup> Avenue West
	West	4 <sup>th</sup> Avenue West
18 <sup>th</sup> Street West	East	4 <sup>th</sup> Avenue West
	West	4 <sup>th</sup> Avenue West
20 <sup>th</sup> Street West	East	4 <sup>th</sup> Avenue West
	East	3 <sup>rd</sup> Avenue West
	West	4 <sup>th</sup> Avenue West
21 <sup>st</sup> Street West	East	4 <sup>th</sup> Avenue West
	West	4 <sup>th</sup> Avenue West
	East	5 <sup>th</sup> Avenue West
	West	5 <sup>th</sup> Avenue West
22 <sup>nd</sup> Street West	East	4 <sup>th</sup> Avenue West
	West	4 <sup>th</sup> Avenue West

SCHEDULE 27 – STOP SIGNS		
Column 1	Column 2	Column 3
Highway	Vehicle Direction	Intersection
23 <sup>rd</sup> Street West	East	3 <sup>rd</sup> Avenue West
	West	8 <sup>th</sup> Avenue West
24 <sup>th</sup> Street West	East	3 <sup>rd</sup> Avenue West
	West	3 <sup>rd</sup> Avenue West
	East	8 <sup>th</sup> Avenue West
	West	8 <sup>th</sup> Avenue West
26 <sup>th</sup> Street West	East	3 <sup>rd</sup> Avenue West
	West	3 <sup>rd</sup> Avenue West
	West	8 <sup>th</sup> Avenue West
27 <sup>th</sup> Street West	East	3 <sup>rd</sup> Avenue West
	West	3 <sup>rd</sup> Avenue West
28 <sup>th</sup> Street West	East	3 <sup>rd</sup> Avenue West
29 <sup>th</sup> Street West	East	3 <sup>rd</sup> Avenue West
Schedule 27 amended by By-law Nos. 2010-105, 2014-068, 2020-025, 2021-107, 2023-050 and 2023-123		



SCHEDULE 27 – STOP SIGNS
ALL WAY STOPS
Intersection of 4 <sup>th</sup> Avenue East and 9 <sup>th</sup> Street East
Intersection of 5 <sup>th</sup> Avenue East and 9 <sup>th</sup> Street East
Intersection of 8 <sup>th</sup> Avenue East and 18 <sup>th</sup> Street East
Intersection of 9 <sup>th</sup> Avenue East and 20 <sup>th</sup> Street East
Intersection of 1 <sup>st</sup> Avenue West and 9 <sup>th</sup> Street West
Intersection of 3 <sup>rd</sup> Avenue West and 9 <sup>th</sup> Street West
Intersection of 3 <sup>rd</sup> Avenue West and 11 <sup>th</sup> Street West
Intersection of 3 <sup>rd</sup> Avenue West and 17 <sup>th</sup> Street West
Intersection of 3 <sup>rd</sup> Avenue West and 18 <sup>th</sup> Street West
Intersection of 4 <sup>th</sup> Avenue West and 19 <sup>th</sup> Street West
Intersection of 4 <sup>th</sup> Avenue West and 23 <sup>rd</sup> Street West
Intersection of 5 <sup>th</sup> Avenue West and 9 <sup>th</sup> Street West
<i>Amended by By-law 2023-050</i>

**SCHEDULE 28 – RESERVED PARKING**

<b>SCHEDULE 28 – RESERVED PARKING</b>		
<b>Column 1</b>	<b>Column 2</b>	<b>Column 3</b>
<b>Designated Persons</b>	<b>City Lands</b>	<b>Time</b>
<b>Market Manager</b>	2 stalls on the east side of the Market Building	At all times
<b>Market Vendors</b>	All stalls in Lot 6 save and except the stalls reserved for the Market Manager	Fridays 11:00 p.m. to Saturdays 2:00 p.m.
<i>Amended by By-law No. 2019-197</i>		